

CITY OF RICHMOND, VIRGINIA

DEPARTMENT OF PUBLIC WORKS

ENGINEERING & TECHNICAL SERVICES

FHWA 534 DATA 47028

FHWA REGION	STATE	FEDERAL PROJECT NUMBER	STATE PROJECT NUMBER
SOUTHEAST	VA	TAP-5B27(049)	

MARCH 2024
60% PRELIMINARY
DESIGN PLANS
NOT FOR CONSTRUCTION

NOTE: ALL WORK TO BE PERFORMED
 WITHIN EXISTING CITY OF
 RICHMOND RIGHT-OF-WAY.



**THESE PLANS ARE UNFINISHED
 AND UNAPPROVED AND ARE
 NOT TO BE USED FOR ANY TYPE
 OF CONSTRUCTION**

SHEET INDEX

DRAWING TITLE	SHEET
COVER SHEET	01
GENERAL CONSTRUCTION NOTES	02(1)
TRANSPORTATION MANAGEMENT PLAN	02(2)
EXISTING CONDITIONS	02(3)
EXISTING TYPICAL SECTIONS	02A
PROPOSED TYPICAL SECTION	02B
43RD ST. PLAN SHEET	03
41ST ST. PLAN SHEET	04
43RD ST. PAVEMENT MARKING & SIGNING SHEET	05
41ST ST. PAVEMENT MARKING & SIGNING SHEET	06
TURNING MOVEMENT 41ST ST.	09
TURNING MOVEMENT 43RD ST.	10

TOTAL SHEETS 12

FOREST HILL AVE. BICYCLE AND PEDESTRIAN SAFETY IMPROVEMENTS

CITY OF RICHMOND PROJECT NUMBER: 108675

AWARD NUMBER: _____

UPC NUMBER: 121414

VDOT PROJECT NUMBER: EN22-127-135

FEDERAL PROJECT NUMBER: TAP-5B27(049)

CITY OF RICHMOND
 APPROVED FOR CONSTRUCTION

DATE	PROJECT MANAGER
DATE	SURVEYS SUPERINTENDENT
DATE	CITY TRANSPORTATION ENGINEER
DATE	CAPITAL PROJECTS ADMINISTRATOR
DATE	CITY ENGINEER
DATE	DIRECTOR OF PUBLIC WORKS

REVISIONS

NO.	DATE	COMMENTS

SIGNED TITLE SHEET AND PLAN SET WILL BE KEPT AT THE CITY OF RICHMOND DPW OFFICE, 900 E. BROAD ST, RICHMOND, VA 23219.

DESIGN FEATURES RELATING TO CONSTRUCTION OR TO REGULATION AND CONTROL OF TRAFFIC MAY BE SUBJECT TO CHANGE AS DEEMED NECESSARY BY THE CITY OF RICHMOND.

THIS PROJECT IS TO BE CONSTRUCTED IN ACCORDANCE WITH THE LATEST VERSIONS OF VDOT'S 2020 ROAD AND BRIDGE SPECIFICATIONS, 2016 ROAD AND BRIDGE STANDARDS, 2011 WORK AREA PROTECTION MANUAL, THE 2009 MUTCD, THE VIRGINIA SUPPLEMENT TO THE 2009 MANUAL ON UNIFORM TRAFFIC CONTROL DEVICES, AND AS AMENDED BY THE CONTRACT PROVISIONS AND THE COMPLETE ELECTRONIC .PDF VERSION OF THE PLAN ASSEMBLY, WHICHEVER IS MORE RESTRICTIVE TAKES PRECEDENCE.

NO ADDITIONAL RIGHT OF WAY REQUIRED FOR THIS PROJECT.

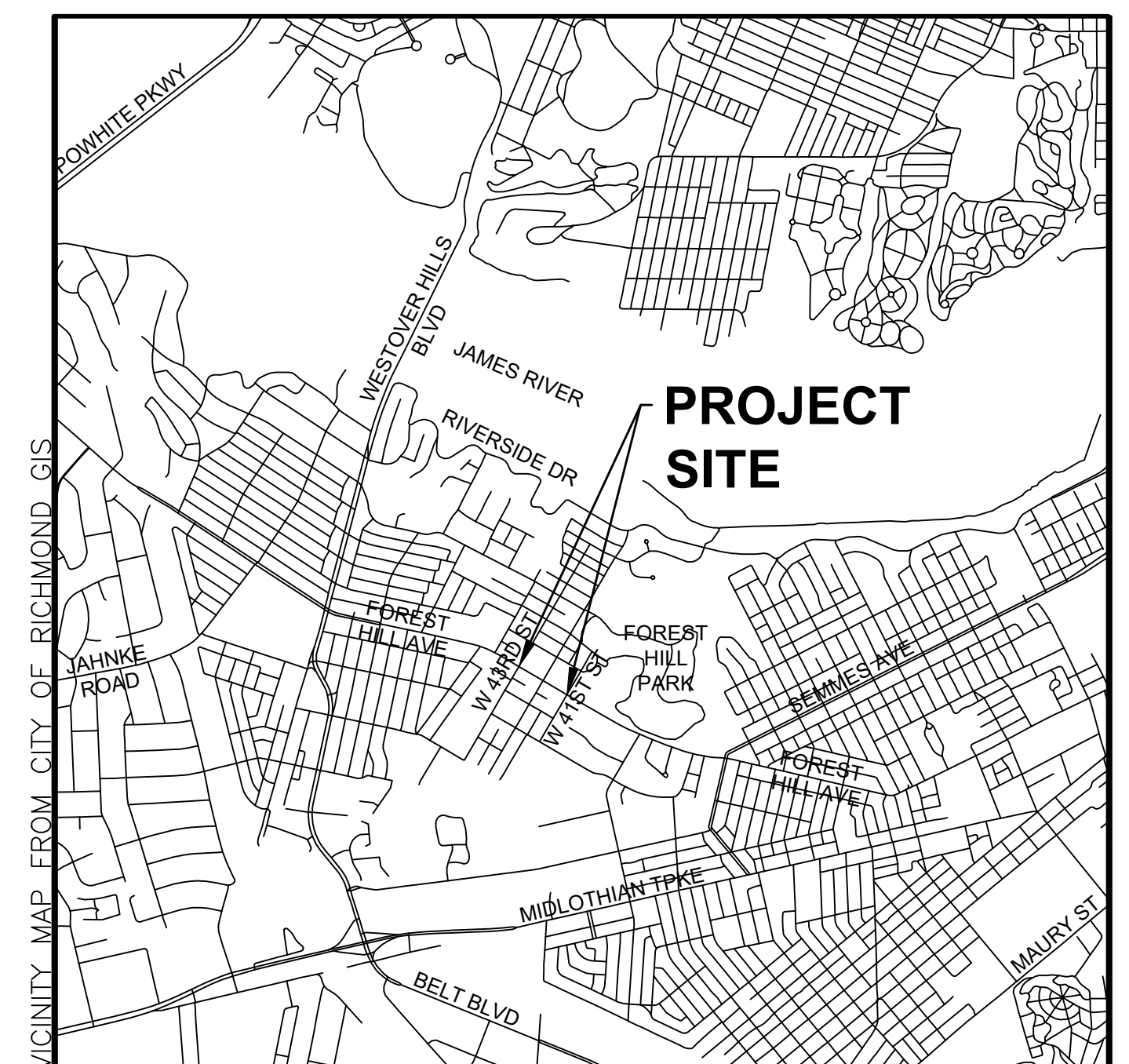

VICINITY MAP

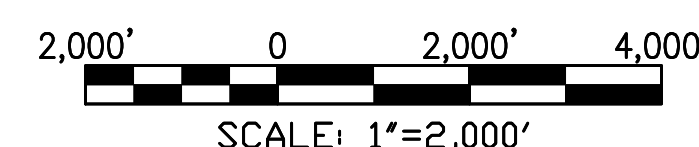

3/8/2024

30 MPH DESIGN SPEED

TIMMONS GROUP
YOUR VISION ACHIEVED THROUGH OURS.
 1001 Boulders Parkway, Suite 300 | Richmond, VA 23225
 TEL 804.200.6500 FAX 804.560.1016 www.timmons.com
JOB# 57064.028

REVISIONS:

DRAWING NO.:

GENERAL CONSTRUCTION NOTES

Timmons Group
Richmond, Virginia
HYDRAULIC/ROADWAY
ENGINEER

GENERAL NOTES

- THE CONTRACTOR SHALL PERFORM ALL WORK AND CONSTRUCTION OR INSTALLATION OF ALL ITEMS WITHIN THE EXISTING CITY OF RICHMOND RIGHT-OF-WAY.
- ALL ITEMS SHALL BE CONSTRUCTED AND INSTALLED IN ACCORDANCE WITH THE LATEST APPLICABLE STANDARDS AND SPECIFICATIONS OF THE CITY OF RICHMOND, THE LATEST STANDARDS AND SPECIFICATIONS OF THE VIRGINIA DEPARTMENT OF TRANSPORTATION (VDOT), VIRGINIA WORK AREA PROTECTION MANUAL, AND THE MANUAL ON UNIFORM TRAFFIC CONTROL DEVICES (MUTCD), WHICHEVER IS MORE RESTRICTIVE, UNLESS OTHERWISE NOTED ON THE PLANS.
- PRIOR TO CONSTRUCTION OR EXCAVATION, THE CONTRACTOR SHALL ASSUME THE RESPONSIBILITY OF LOCATING ANY UNDERGROUND UTILITIES (PUBLIC OR PRIVATE) THAT MAY EXIST AND CROSS THROUGH THE AREA OF CONSTRUCTION. THE CONTRACTOR SHALL BE RESPONSIBLE FOR REPAIRING, AT HIS EXPENSE, ANY EXISTING UTILITIES DAMAGED DURING CONSTRUCTION. THE LOCATION OF EXISTING LINES, CONDUITS, OR OTHER STRUCTURES ACROSS, UNDERNEATH, OR OTHERWISE ALONG THE LINE OF PROPOSED WORK AS SHOWN ON THE PLANS ARE APPROXIMATE AS PROVIDED BY CITY OF RICHMOND GIS MAPPING DATA. ALL EXISTING UTILITIES IN THE PROJECT LIMITS ARE NOT GUARANTEED TO BE SHOWN ON THE PLANS. THE CONTRACTOR SHALL BE LIABLE FOR ALL DAMAGE DONE TO ANY STRUCTURES OR PROPERTY THROUGH HIS NEGLIGENCE OR CARELESSNESS. THE PROJECT MANAGER SHALL BE CONTACTED IMMEDIATELY IF LOCATION OR ELEVATION IS DIFFERENT FROM THAT SHOWN ON THE PLANS. IF THERE APPEARS TO BE A CONFLICT, OR UPON DISCOVERY OF ANY UTILITY NOT SHOWN ON THE PLANS. THE CONTRACTOR SHALL CONTACT "MISS UTILITY" (1-800-552-7001) PRIOR TO START OF CONSTRUCTION.
- THE CONTRACTOR SHALL BE RESPONSIBLE FOR OBTAINING ALL NECESSARY PERMITS FROM THE CITY OF RICHMOND PRIOR TO COMMENCEMENT OF CONSTRUCTION.
- THE CONTRACTOR SHALL NOTIFY THE CITY TRAFFIC ENGINEERING DIVISION IN WRITING 72 HOURS PRIOR TO THE BEGINNING OF CONSTRUCTION.
- ANY DEVIATION FROM THE APPROVED PLANS AND/OR STANDARDS AND SPECIFICATIONS MUST BE APPROVED BY THE CITY TRAFFIC ENGINEERING DIVISION IN WRITING PRIOR TO START OF WORK.
- IF A CONFLICT IS FOUND, THE CONTRACTOR SHALL NOTIFY THE CITY TRAFFIC ENGINEERING DIVISION BEFORE ANY WORK IS STARTED IN ORDER TO COORDINATE THE REMAINDER OF THE WORK TO BE DONE.
- THE CONTRACTOR SHALL MAINTAIN UTILITY SERVICES TO EXISTING RESIDENCES AND BUSINESSES DURING CONSTRUCTION. WHEN SERVICES ARE TO BE INTERRUPTED FOR CUT-INS, PLUGGING, OR ABANDONMENT ETC., THE CONTRACTOR SHALL PROVIDE THE CITY WITH 72 HOURS NOTICE. THE AFFECTED PROPERTY OWNER, RESIDENCE OR BUSINESS SHALL BE NOTIFIED 48 HOURS IN ADVANCE OF SERVICE INTERRUPTIONS. ALL UTILITY SERVICE INTERRUPTIONS SHALL BE KEPT TO AN ABSOLUTE MINIMUM. THE CONTRACTOR SHALL PROVIDE THE PROJECT MANAGER WITH A DETAILED PLAN AND SCHEDULE FOR SERVICE INTERRUPTIONS A MINIMUM OF FIVE (5) WORKING DAYS IN ADVANCE OF SUCH WORK.
- THE CONTRACTOR SHALL BE RESPONSIBLE FOR PROTECTING EXISTING UTILITIES AND SHALL REPLACE AT NO ADDITIONAL COST, IF DAMAGED, AS DIRECTED BY THE CITY. EXISTING UTILITIES THAT ARE IN CONFLICT AND MAY NEED TO BE REMOVED OR RELOCATED WILL BE COORDINATED BY THE CITY. RELOCATIONS OF CITY FACILITIES WILL BE ADMINISTERED BY THE CITY DEPARTMENT OF PUBLIC UTILITIES. IN CASE OF EMERGENCIES OF UTILITY BREAKAGE/CONFLICT CONTACT:

UTILITY	TELEPHONE NUMBER
GAS	646-8300, 646-8309, 646-8310
WATER	646-8300, 646-8309, 646-8310
SEWER	646-8600, 646-8426
POWER	888-667-3000
- ALL UTILITY CLEARANCES ARE THE RESPONSIBILITY OF THE CONTRACTOR AND SHALL BE OBTAINED PRIOR TO CONSTRUCTION. EXCAVATION WITHIN 1.5' OF GAS OR ELECTRIC LINES SHALL BE PERFORMED BY HAND.
- THE CONTRACTOR SHALL SUBMIT A SEPARATE INTERSECTION TRANSITION PLAN TO THE ENGINEER FOR APPROVAL A MINIMUM OF 48 HOURS PRIOR TO COMMENCEMENT OF INTERSECTION CONSTRUCTION. INCLUDED IN THIS PLAN SHALL BE TRAFFIC MAINTENANCE PROCEDURES TO BE USED DURING CONSTRUCTION. SEE TRAFFIC MANAGEMENT PLAN NARRATIVE.
- INSTALLATION DIMENSIONS SHOWN WITHIN THE PLANS ARE APPROXIMATE. MODIFICATIONS SHALL BE MADE AS REQUIRED UNDER APPROVAL FROM THE ENGINEER.
- DESIGN FEATURES RELATING TO CONSTRUCTION OR TO REGULATION AND CONTROL OF TRAFFIC MAY BE SUBJECT TO CHANGE AS DEEMED NECESSARY BY THE CITY OF RICHMOND.
- THE CONTRACTOR SHALL ADEQUATELY SUPPORT, AND BE RESPONSIBLE FOR, ALL UTILITY LINES EXPOSED AS A RESULT OF CONSTRUCTION ACTIVITY SHOWN ON THE PLANS.

PAVEMENT MARKING AND SIGNING NOTES

- THE CONTRACTOR SHALL PREPARE THE PAVEMENT SURFACE FOR PROPER ADHESION. ANY SWEEPING OR REMOVAL OF DEBRIS, GRAVEL, DIRT, OR OTHER FOREIGN MATERIALS SHALL BE CONSIDERED AS INCIDENTAL TO THE INSTALLATION.
- THE CONTRACTOR SHALL REMOVE COMPLETELY ALL PREVIOUS PAVEMENT MARKINGS, WHICH, IN THE OPINION OF THE PROJECT MANAGER, CONFLICT WITH THE NEW PAVEMENT MARKINGS.
- UNLESS OTHERWISE SPECIFIED, THE BASIS OF MEASUREMENT SHALL BE ALONG THE LONGITUDINAL CENTERLINE OF PAVEMENT MARKINGS. MEASUREMENT FOR LEGENDS SHALL BE PER MESSAGE, COMPLETE AND IN PLACE.
- PRIOR TO APPLICATION, THE CONTRACTOR SHALL FIELD CHECK AND LOCATE ALL PAVEMENT MARKINGS TO THE SATISFACTION OF THE PROJECT MANAGER.
- ALL MARKINGS IMPROPERLY APPLIED OR LOCATED SHALL BE REMOVED AND CORRECTLY REAPPLIED, AT THE CONTRACTOR'S EXPENSE.
- THERMOPLASTIC PAVEMENT MARKINGS SHALL NOT BE INSTALLED AT ANYTIME WITHIN A FORTY-EIGHT (48) HOUR PERIOD FOLLOWING A RAINFALL.
- MARKING MATERIAL SHALL BE APPLIED AT THE SPECIFIED DIMENSIONS AND AT A RATE TO RESULT IN A MARKING THICKNESS OF 90 MILS ± 5 MILS (NOT INCLUDING GLASS BEAD TOP DRESSING).
- THE MARKINGS SHALL BE PROVIDED IN SPECIFIED WIDTHS AND SHAPES. PREFORMED WORKS AND SYMBOLS SHALL CONFORM TO THE APPLICABLE SHAPES AND SIZES OUTLINED IN THE "MANUAL ON UNIFORM TRAFFIC CONTROL DEVICES" FOR STREETS AND HIGHWAYS, LATEST EDITION.
- THE CONTRACTOR SHALL ENSURE THAT A 4" DIAMETER PVC SLEEVE IS PLACED IN IMPERVIOUS AREAS SUCH AS CONCRETE SIDEWALKS TO PERMIT THE INSTALLATION OF GROUND-MOUNTED SIGNS AT THESE LOCATIONS.
- UNLESS OTHERWISE SPECIFIED ON THE PLANS OR IN CONTRACT DOCUMENTS, ALL PAVEMENT MARKINGS AND LEGENDS IN THE PUBLIC RIGHT-OF-WAY SHALL BE IN ACCORDANCE WITH LATEST VERSION OF THE VDOT SPECIFICATIONS AND THE MUTCD.
- SIGN LOCATIONS SHALL BE VERIFIED BY THE PROJECT MANAGER AND/OR THE ENGINEER PRIOR TO INSTALLATION. SIGNS SHALL CONFORM TO THE CURRENT VDOT SPECIFICATIONS AND STANDARDS AND THE MUTCD. EXISTING SIGNS NOT NEEDED SHALL BE REMOVED AND TURNED OVER TO THE DEPARTMENT OF PUBLIC WORKS DESIGNATED LOCATION.
- SOLID WHITE LINES SHALL COMPLETELY TRAVERSE ALL TRAFFIC LANES.
- CENTERLINES ON UNDIVIDED ROADWAYS SHALL BE SOLID DOUBLE YELLOW LINES, 4" WIDE, SEPARATED BY A 4" SPACE.

CITY OF RICHMOND EROSION AND SEDIMENT CONTROL NOTES

- THIS PROJECT IS LOCATED WITHIN THE LIMITS OF TIDEWATER, AS DEFINED BY THE CHESAPEAKE BAY PRESERVATION ACT. THEREFORE, IF LAND DISTURBANCE WERE GREATER THAN 2,500 SF, AN EROSION AND SEDIMENT CONTROL PLAN WOULD BE REQUIRED; HOWEVER, LAND DISTURBANCE IS LESS THAN 2,500 SF SO THIS PROJECT IS EXEMPT FROM A FORMAL EROSION AND SEDIMENT CONTROL PLAN.
- PERMANENT OR TEMPORARY SOIL STABILIZATION SHALL BE APPLIED TO DENUDED AREAS WITHIN SEVEN DAYS AFTER FINAL GRADE IS REACHED ON ANY PORTION OF THE SITE. TEMPORARY SOIL STABILIZATION SHALL BE APPLIED WITHIN SEVEN DAYS TO DENUDED AREAS THAT MAY NOT BE AT FINAL GRADE BUT WILL REMAIN DORMANT (UNDISTURBED) FOR LONGER THAN 14 DAYS. PERMANENT STABILIZATION SHALL BE APPLIED TO AREAS THAT ARE TO BE LEFT DORMANT FOR MORE THAN ONE YEAR.
- EXCESS EXCAVATION DISPOSED OF OFF THE SITE SHALL BE DISPOSED OF IN ACCORDANCE WITH THE VIRGINIA EROSION AND SEDIMENT CONTROL HANDBOOK.
- EROSION AND SEDIMENT CONTROLS SHALL BE INSTALLED IN ACCORDANCE WITH THE VIRGINIA EROSION AND SEDIMENT CONTROL HANDBOOK AND SHALL BE PLACED PRIOR TO OR AS THE FIRST STEP OF THE LAND DISTURBING ACTIVITY.
- EROSION AND SEDIMENT CONTROL SHALL BE MAINTAINED SO THAT SEDIMENT CARRYING RUNOFF FROM THE SITE WILL NOT ENTER STORM DRAINAGE FACILITIES.
- EROSION AND SEDIMENT CONTROLS SHALL BE MAINTAINED UNTIL THE DISTURBED AREA IS STABILIZED.
- PROPERTIES ADJOINING THE SITE SHALL BE KEPT CLEAN OF MUD OR SILT CARRIED FROM THE SITE BY VEHICULAR TRAFFIC OR RUNOFF.
- THE DISPOSAL OF WASTE MATERIALS REMOVED FROM EROSION AND SEDIMENT CONTROL FACILITIES AND THE DISPOSAL OF THESE FACILITIES SHALL BE IN ACCORDANCE WITH THE VIRGINIA EROSION AND SEDIMENT CONTROL HANDBOOK.
- DURING CONSTRUCTION OF THE PROJECT, SOIL STOCKPILES SHALL BE STABILIZED OR PROTECTED WITH SEDIMENT TRAPPING MEASURES. THE APPLICANT IS RESPONSIBLE FOR THE TEMPORARY PROTECTION AND PERMANENT STABILIZATION OF ALL SOIL STOCKPILES ON SITE AS WELL AS SOIL INTENTIONALLY TRANSPORTED FROM THE PROJECT SITE.
- ALL EROSION AND SEDIMENT CONTROL MEASURES SHALL BE CHECKED DAILY AND AFTER EACH RUNOFF PRODUCING RAINFALL.
- CONSTRUCTION SEQUENCES ARE FOR REFERENCE ONLY, THE CONTRACTOR IS RESPONSIBLE FOR INSTALLING EROSION AND SEDIMENT CONTROLS AS NECESSARY, INCLUDING COORDINATING WITH THE PROJECT INSPECTOR.

EROSION & SEDIMENT CONTROL SEQUENCE OF CONSTRUCTION

- COORDINATE WITH CITY OF RICHMOND DEPARTMENT OF PUBLIC UTILITIES (DPU) AND THE ASSIGNED CONSTRUCTION INSPECTOR ON EXACT LOCATIONS OF LAND DISTURBANCE AND POTENTIAL AFFECTED INLETS AND DRAINAGE AREAS.
- ALL STORM SEWER INLETS AND DRAINAGE INLET STRUCTURES ARE TO BE PROTECTED BY THE APPROPRIATE INLET PROTECTION MEASURES, AS DESCRIBED WITHIN THE VIRGINIA EROSION AND SEDIMENT CONTROL HANDBOOK.
- AS THE PROJECT PROGRESSES, THE CONTRACTOR IS RESPONSIBLE FOR MAINTAINING, ADJUSTING, AND RELOCATING ALL EROSION CONTROL MEASURES TO ENSURE SEDIMENT IS CONTAINED.
- INSPECTIONS AND APPROVAL FOR COMPLETION OF INSTALLATION OF EROSION AND SEDIMENT CONTROL MEASURES SHALL BE FROM THE CITY OF RICHMOND OR ITS DESIGNATED INSPECTOR.
- THE CITY OF RICHMOND AND/OR ITS INSPECTOR MAY REQUIRE ADDITIONAL EROSION CONTROL MEASURES, BEYOND THOSE DESCRIBED WITHIN THESE NOTES, BASED ON FIELD CONDITIONS, AT THE CONTRACTOR'S EXPENSE.

PEDESTRIAN CROSSWALK MARKING DETAIL

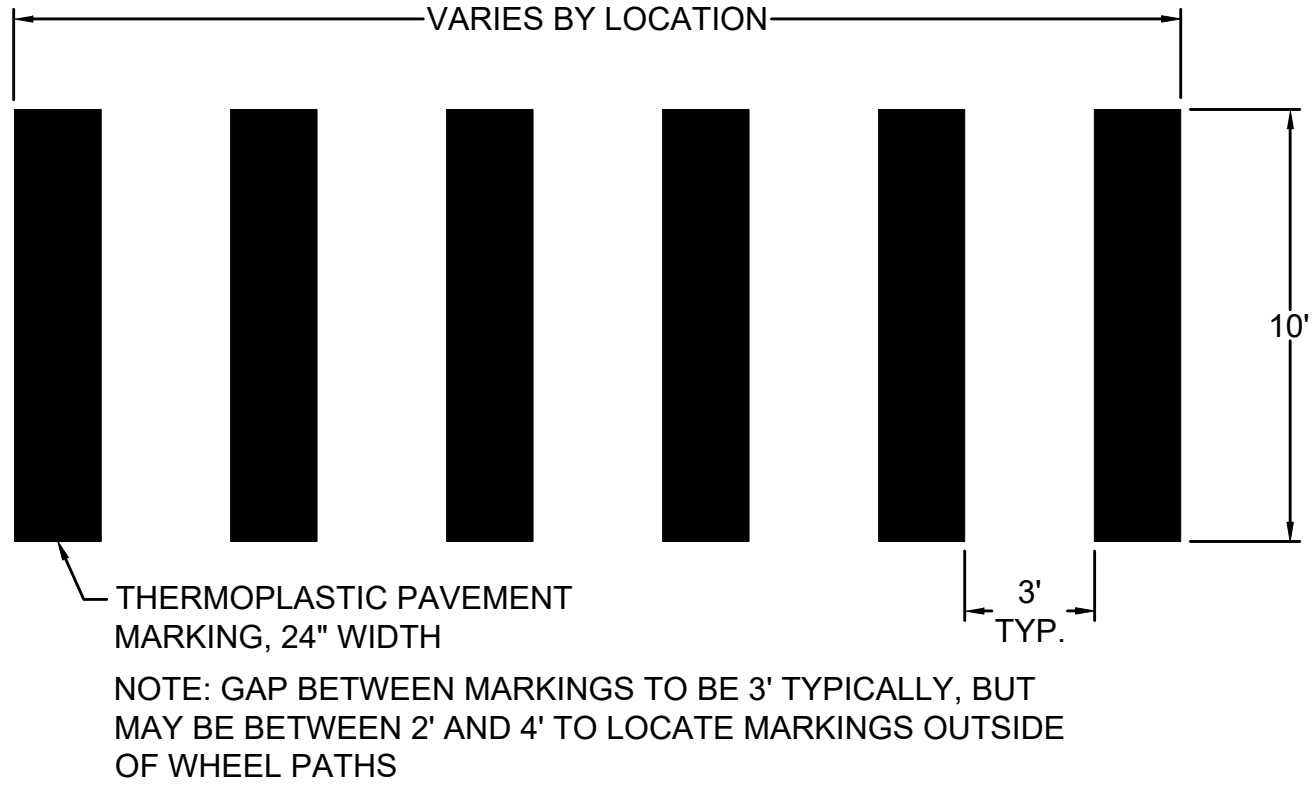

CURB TRANSITION DETAIL

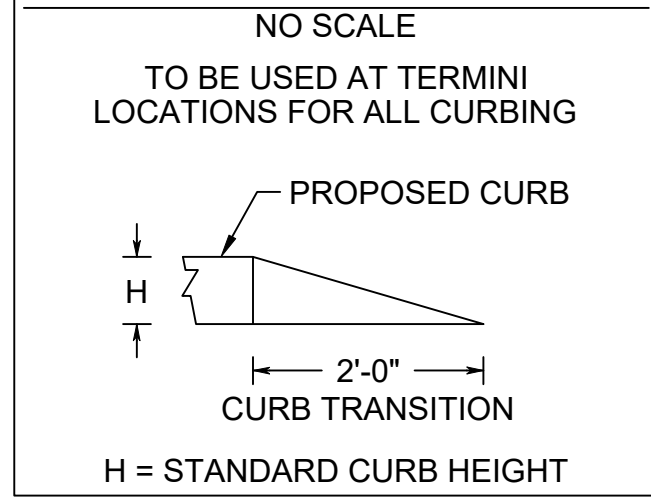

PATTERN LEGEND

- MILL & OVERLAY EXISTING PAVEMENT (2" MILL, 2" OVERLAY SM-12.5D ASPH. CONC.)
- ASPHALT PAVING
- DETECTABLE WARNING SURFACE

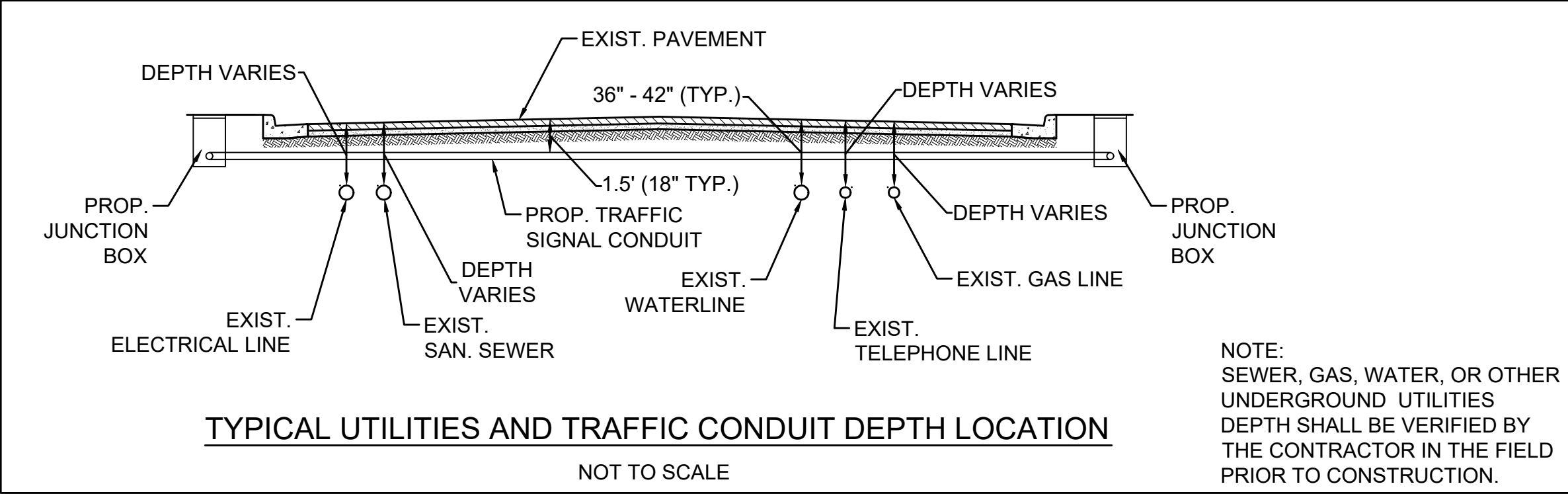

**MARCH 2024
60% PRELIMINARY
DESIGN PLANS
NOT FOR CONSTRUCTION**

**THESE PLANS ARE UNFINISHED
AND UNAPPROVED AND ARE
NOT TO BE USED FOR ANY TYPE
OF CONSTRUCTION**

NOTES
1. Lot dimensions in parentheses are from deed.
2. Property owners correct as of December, 2018
3. Ordinance Number <u>N/A</u>
4. Adopted <u>N/A</u>
5. Accepted <u>N/A</u>

REFERENCES
REVISIONS

Existing Curb
• Curb & Gutter
• Sidewalk
• Basin
• Storm Sewer
• Sewer Manhole
• Sanitary Sewer (small)
• Sanitary Sewer (large)
• Gas Line
• Electric Line
• Telephone/Telegraph
• TV Cable
• Water Line
• Tree / Exist. Tree To Be Removed
• Property Line

-LEGEND-
Existing Curb Cut Ramp
• Coping
• Alley Crossing/Driveway
• Fire Hydrant
• Edge of Pavement
• Fence
• Cornerstone
• Property Pin
• Utility Pole
Proposed Sewer
• Manhole
• Basin
• Curb & Gutter
• Asphalt

Proposed Conc. Sidewalk
• Brick Sidewalk
Castings: Water Valve
• Water Meter
• Gas Drip
• Gas Valve
• Telephone Manhole
• Electric Manhole
Proposed Curb Cut Ramp
• Decorative Light
• Conduit
• Conduit (Enc. Encased)
• Retaining Wall



DESIGN BY: DRG	REVIEWED BY: CCC	FIELD NOTES: FB-XX, pp XX-XX	SCALE: HORZ. N/A, VERT. N/A	DATE: -/-/-	SHEET: 02(1)	DRAWING NO.:
----------------	------------------	------------------------------	-----------------------------	-------------	--------------	--------------

SURVEYED BY:

DESIGNED BY:

L:\2025\764-Richmond_CIP - On-Call\2025-2026-Event_Hill_PEP - 7657\DWG\Sheet\20250209_028-2026-CIP.dwg | Plotted on 3/8/2024 1:02 PM | by Vince Sheehan

TRANSPORTATION MANAGEMENT PLAN

GENERAL NOTES

- THIS PROJECT IS CLASSIFIED AS TYPE A, UNDER THE VDOT CLASSIFICATION SYSTEM.
- THE PURPOSE OF THIS PROJECT IS TO PROVIDE PEDESTRIAN SAFETY IMPROVEMENTS ALONG FOREST HILL AVE AT W 41ST STREET AND W 43RD STREET BY RELOCATING RRFBS TO INCREASE CONSPICUITY OF THE BEACONS AND REDUCE PEDESTRIAN CROSSING DISTANCES.
- TRAFFIC IN THE PROJECT VICINITY CONSISTS PRIMARILY OF RESIDENTIAL TRAFFIC AND SCHOOL TRAFFIC.
- THE EXISTING POSTED SPEED LIMIT FOR FOREST HILL AVENUE IS 30 MPH AND THE SPEED LIMIT IS 25 MPH FOR THE SURROUNDING PROJECT STREETS THAT DO NOT HAVE A POSTED SPEED LIMIT SIGN. ALL EXISTING SPEED LIMITS ARE EXPECTED TO BE MAINTAINED DURING CONSTRUCTION.

TRANSPORTATION OPERATION PLAN

- THE CONTRACTOR MUST ADVISE EMERGENCY COMMUNICATIONS OF THE CITY AT 804-646-5700 ON ALL PLANNED LANE CLOSURES 24 HOURS IN ADVANCE.
- IN CASE OF EMERGENCY, CALL 911.

THE FOLLOWING IS A LIST OF LOCAL NON-EMERGENCY NUMBERS:
CITY FIRE: 804-646-2500
CITY POLICE: 804-646-5100
STATE POLICE: 804-379-8645
PROJECT PERSONNEL:
ENGINEER CONTACT: TIMMONS GROUP, THOMAS RUFF, 804-200-6430
CITY OF RICHMOND DEPARTMENT OF PUBLIC WORKS (DPW) - TRANSPORTATION ENGINEERING: MARITZA FELIZ-REYES, 804-646-6334
- TRAFFIC INCIDENTS THAT MAY OCCUR IN THE WORK ZONE:
 - INSPECTOR SHALL NOTIFY CITY PROJECT MANAGER OF THE TRAFFIC INCIDENT AND TAKE PICTURES OF THE WORK ZONE SETUP.
 - CONTRACTOR MAY HAVE TO SHUT DOWN THE WORK DEPENDING UPON THE INCIDENT SEVERITY.
 - THE CITY POLICE WILL DETERMINE THE RESPONSE NECESSARY TO ALLOW TRAVELING PUBLIC AROUND INCIDENT, TAKE CONTROL OF THE INCIDENT, AND DIRECT ITS CLEARING AND RESTORATION TO NORMAL TRAFFIC CONDITIONS.
- THE CITY POLICE INCIDENT REPORT WILL BE REVIEWED BY THE CITY PROJECT MANAGER AT 804-646-6334. ANY TRAFFIC INCIDENT (IF APPLICABLE) THAT OCCURS DURING THE LIFE OF THIS PROJECT WILL BE DISCUSSED BY THE CONTRACTOR, DPW, AND THE ENGINEER OF RECORD TO DETERMINE WHETHER ANY CHANGES NEED TO BE MADE TO THE TRAFFIC CONTROL ON THE PROJECT.

TRANSPORTATION MANAGEMENT PLAN (TMP) GENERAL NOTES

- THE CONTRACTOR WILL MAKE ARRANGEMENTS TO STORE EQUIPMENT AND MATERIALS.
- CONTRACTOR SHALL USE THE TMP AS A STARTING POINT FOR APPROPRIATE WORK ZONE TRAFFIC CONTROL. THIS PLAN IS NOT INTENDED TO BE THE FINAL TMP. THE CONTRACTOR IS EXPECTED TO SUBMIT A TMP FOR EACH CONSTRUCTION LOCATION AND HAVE THE PLAN APPROVED BY THE INSPECTOR AND/OR THE CITY ENGINEER PRIOR TO FIELD IMPLEMENTATION.
- ANY REQUIRED LANE CLOSURES MUST BE APPROVED IN ADVANCE BY THE DPW ENGINEER.
- LANE CLOSURES WILL NOT BE PERMITTED ON HOLIDAYS, WEEKENDS, OR ON FRIDAY-SATURDAY-SUNDAY-MONDAY SURROUNDING HOLIDAY WEEKENDS UNLESS OTHERWISE APPROVED IN ADVANCE BY DPW.
- VEHICULAR AND PEDESTRIAN ACCESS TO ADJACENT PROPERTIES AND CONNECTING STREETS SHALL BE MAINTAINED AT ALL TIMES DURING CONSTRUCTION. PROPERTY OWNERS SHALL BE NOTIFIED A MINIMUM OF 48 HOURS PRIOR TO ANY ACTIVITIES WHICH WOULD IMPEDE ACCESS TO THEIR PROPERTY.
- CONTRACTOR SHALL PROVIDE ADDITIONAL TRAFFIC CONTROL AS DIRECTED BY DPW, SHOULD FIELD CONDITIONS WARRANT.
- CONTRACTOR MAY REDUCE LANE WIDTHS TO 10' MINIMUM DURING CONSTRUCTION.
- CONSTRUCTION SHALL BE PROHIBITED ON STREETS BETWEEN THE HOURS OF 7:00 AM TO 9:00 AM AND 4:00 PM TO 6:00 PM, MONDAY THROUGH FRIDAY, UNLESS AUTHORIZATION IS RECEIVED FROM THE CITY PROJECT MANAGER IN WRITING IN ADVANCE OF THE WORK.
- ANY WORK ACTIVITIES BETWEEN THE HOURS OF 11:00 PM TO 7:00 AM SHALL BE IN ACCORDANCE WITH THE CITY'S NOISE ORDINANCE.

Timmons Group
Richmond, Virginia
HYDRAULIC/ROADWAY
ENGINEER

TEMPORARY TRAFFIC CONTROL / MAINTENANCE OF TRAFFIC

- THE WORK ZONE SHALL BE MAINTAINED ACCORDING TO THE CITY'S DEPARTMENT OF PUBLIC WORKS SPECIAL PROVISIONS. ALSO THE FOLLOWING TRAFFIC CONTROL SPECIFICATIONS FROM THE VDOT 2011 WORK AREA PROTECTION MANUAL (REVISION 2: SEPTEMBER 1, 2019 REVISION) WILL BE USED.
 - TYPICAL TRAFFIC CONTROL - STATIONARY OPERATION ON SHOULDER (FIGURE TTC-4.2)
 - TYPICAL TRAFFIC CONTROL - SHOULDER OPERATION WITH MINOR ENCROACHMENT (FIGURE TTC-5.2)
 - TYPICAL TRAFFIC CONTROL - LANE CLOSURE ON A TWO-LANE ROADWAY USING FLAGGERS (FIGURE TTC-23.2)
 - TYPICAL TRAFFIC CONTROL - LANE CLOSURE OPERATION IN AN INTERSECTION (FIGURE TTC-28.2)
 - TYPICAL TRAFFIC CONTROL - STREET CLOSURE OPERATION WITH DETOUR (FIGURE TTC-34.2)
 - TYPICAL TRAFFIC CONTROL - SIDEWALK CLOSURE AND BYPASS SIDEWALK OPERATION (FIGURE TTC-35.1).
- ACCESS TO ADJACENT PROPERTIES SHALL BE MAINTAINED AT ALL TIMES.
- IF THE CONTRACTOR IMPLEMENTS A DETOUR ROUTE DURING CONSTRUCTION, THE CONTRACTOR SHALL COORDINATE ALL STREET CLOSURES AND DETOURS WITH THE CITY OF RICHMOND PROJECT MANAGER. PLEASE NOTIFY VDOT IF ANY PRIMARY ROUTES ARE IMPACTED.



PUBLIC COMMUNICATION PLAN

- A PUBLIC COMMUNICATIONS PLAN IS NOT APPLICABLE TO THIS PROJECT, ALTHOUGH PLANNED LANE CLOSURES WILL BE ANNOUNCED TO THE LOCAL MEDIA.

**MARCH 2024
60% PRELIMINARY
DESIGN PLANS
NOT FOR CONSTRUCTION**

SURVEYED BY:
SUPERVISED BY:
DESIGNED BY:

L:\2024\2404-Richmond_CIP - On-Call\2024-05-Forest Hill_PEP_7857\DWG\Sheet\20240504.dwg | Printed on 3/8/2024 1:02 PM by Vince Sheehan

NOTES 1. Lot dimensions in parentheses are from deed. 2. Property owners correct as of December, 2018 3. Ordinance Number N/A 4. Adopted N/A 5. Accepted N/A		LEGEND Existing Curb • Curb & Gutter • Sidewalk • Basin • Storm Sewer • Sewer Manhole • Sanitary Sewer (open) • Sanitary Sewer (over man) • Gas Line • Electric Line • Telephone/Telegraph • TV Cable • Water Line • Tree / Exist. Tree To Be Removed • Property Line		Existing Curb Cut Ramp • Coping • Alley Crossing/Driveway • Fire Hydrant • Edge of Pavement • Fence • Cornerstone • Property Pin • Utility Pole Proposed Sewer • Manhole • Basin • Curb & Gutter • Asphalt		Proposed Conc. Sidewalk • Brick Sidewalk Castings: Water Valve • Water Meter • Gas Drip • Gas Valve • Telephone Manhole • Electric Manhole Proposed Curb Cut Ramp • Decorative Light • Conduit • Conduit (Conc. Encased) • Retaining Wall		  <p>DEPARTMENT OF PUBLIC WORKS RICHMOND, VIRGINIA</p>	 <p>TIMMONS GROUP ENGINEERING DESIGN TECHNOLOGY</p>	FOREST HILL AVE. BICYCLE AND PEDESTRIAN SAFETY IMPROVEMENTS TRANSPORTATION MANAGEMENT PLAN		DESIGN BY: DRL DRAUGHT BY: CCC CHECKED BY: DRL	REVIEWED BY:	FIELD NOTES FB-1X, PP 1X-1X	SCALE HORIZ. N/A VERT. N/A	DATE -/-/-	SHEET 02(2)	DRAWING NO.
--	--	---	--	---	--	---	--	--	--	--	--	--	--------------	--------------------------------	----------------------------------	---------------	----------------	-------------

**MARCH 2024
60% PRELIMINARY
DESIGN PLANS
NOT FOR CONSTRUCTION**

Timmons Group
Richmond, Virginia
HYDRAULIC/ROADWAY
ENGINEER

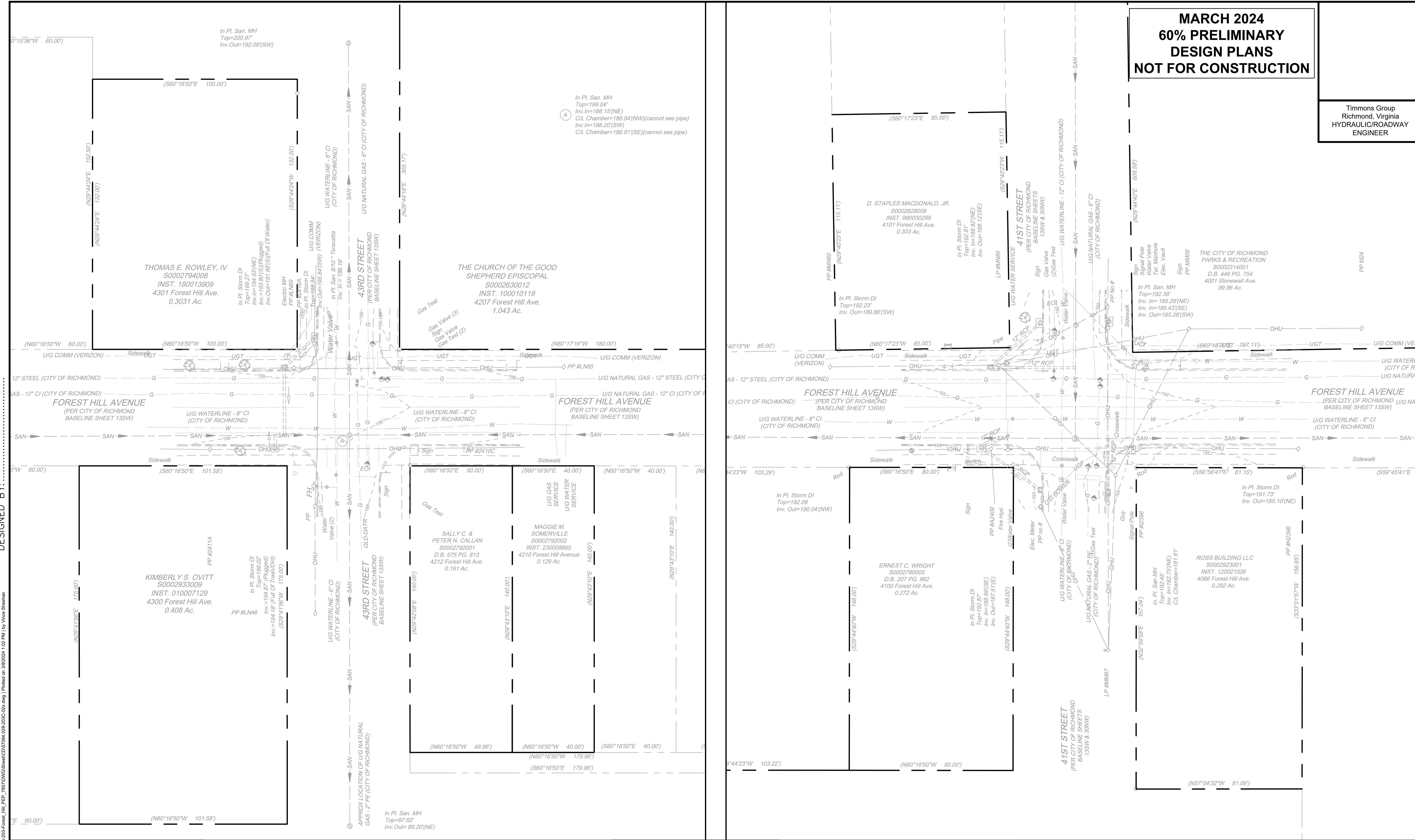

SURVEYED BY: _____
SUPERVISED BY: _____
DESIGNED BY: _____

L:\2023\764-Richmond_CIP - On-Call\2023-2025-Forest_Hill_PEP_7857\DWG\Sheet\2023-2025-Forest_Hill_PEP_7857.dwg | Printed on 3/8/2024 1:02 PM by Vince Sheehan

NOTES

1. Lot dimensions in parentheses are from deed.
2. Property owners correct as of December, 2018
3. Ordinance Number N/A
4. Adopted N/A
5. Accepted N/A

EXISTING	PROPOSED
<ul style="list-style-type: none"> Existing Curb Curb & Gutter Sidewalk Basin Storm Sewer Sewer Manhole Sanitary Sewer (Open) Sanitary Sewer (Open Man) Gas Line Electric Line Telephone/Telegraph TV Cable Water Line Tree / Exist. Tree To Be Removed Property Line 	<ul style="list-style-type: none"> Proposed Conc. Sidewalk Brick Sidewalk Castings: Water Valve Water Meter Gas Drip Gas Valve Telephone Manhole Electric Manhole Proposed Curb Cut Ramp Decorative Light Conduit Conduit (Conc. Encased) Retaining Wall

DEPARTMENT OF PUBLIC WORKS
RICHMOND, VIRGINIA

TIMMONS GROUP
ENGINEERING | DESIGN | TECHNOLOGY

FOREST HILL AVE. BICYCLE AND PEDESTRIAN SAFETY IMPROVEMENTS
EXISTING CONDITIONS

DESIGN BY: DRL	REVIEWED BY:	FIELD NOTES: FB-1X, PP 1X-1X	SCALE: HORZ. N/A, VERT. N/A	DATE: -/-/-	SHEET: 02(3)	DRAWING NO.:
----------------	--------------	------------------------------	-----------------------------	-------------	--------------	--------------

Timmons Group
Richmond, Virginia
HYDRAULIC/ROADWAY
ENGINEER

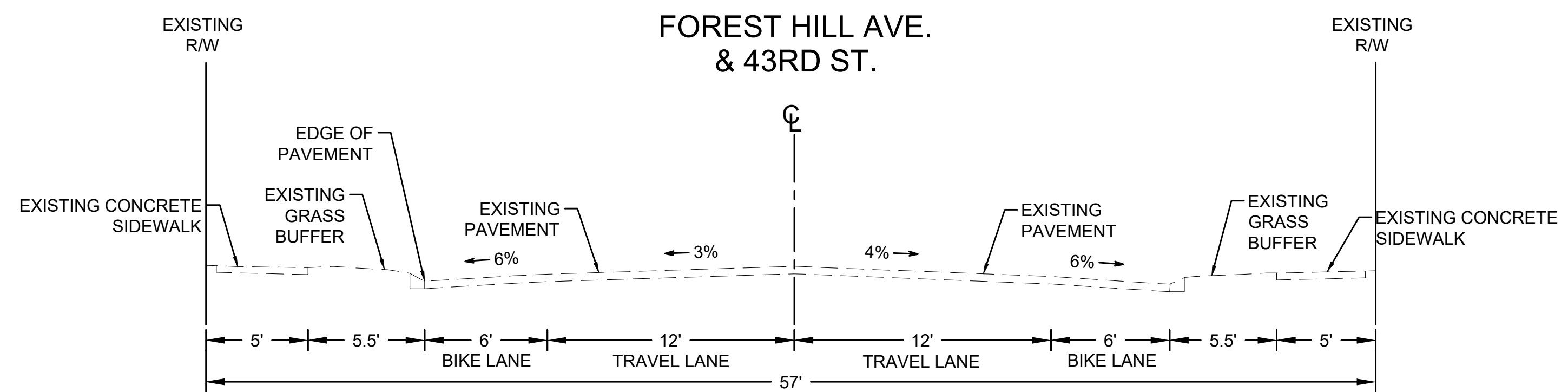
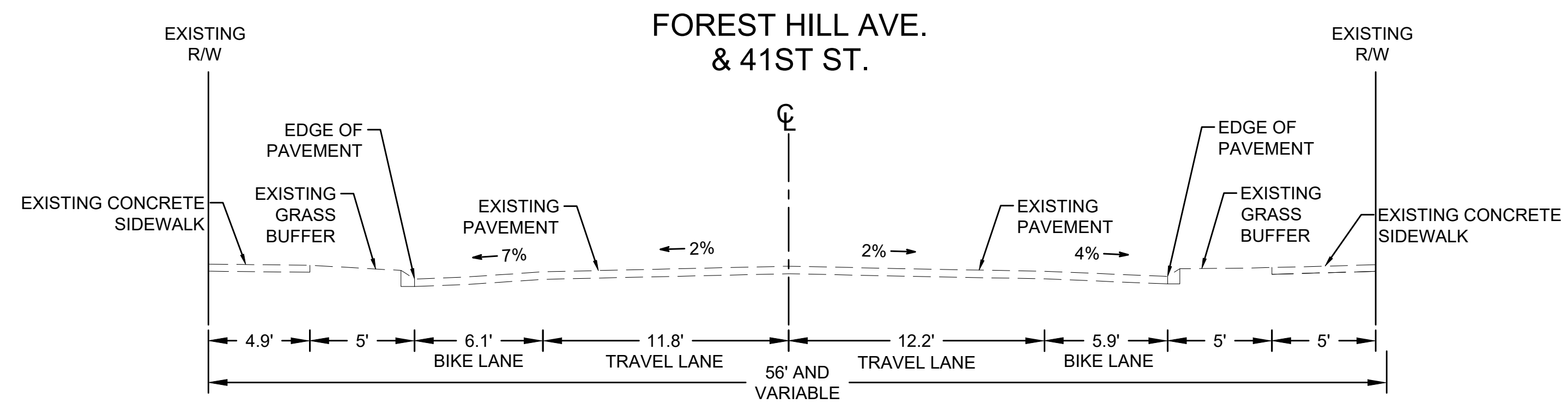

MARCH 2024
60% PRELIMINARY
DESIGN PLANS
NOT FOR CONSTRUCTION

SURVEYED BY:
SUPERVISED BY:
DESIGNED BY:

L:\2023\76764-Richmond_CIP_Or-Call\028-204-Forest_Hill_PREF_7657\DWG\Sheet\CD\57\04_028-204-C-02A.dwg | Printed on 3/8/2024 1:01 PM | by Vince Sheehan

NOTES

1. Lot dimensions in parentheses are from deed.
2. Property owners correct as of December, 2018
3. Ordinance Number N/A
4. Adopted N/A
5. Accepted N/A

Existing Curb	Symbol
Curb & Gutter	[Symbol]
Sidewalk	[Symbol]
Basin	[Symbol]
Storm Sewer	[Symbol]
Sewer Manhole	[Symbol]
Sanitary Sewer (sewer)	[Symbol]
Sanitary Sewer (raw main)	[Symbol]
Gas Line	[Symbol]
Electric Line	[Symbol]
Telephone/Telegraph	[Symbol]
TV Cable	[Symbol]
Water Line	[Symbol]
Tree / Exist. Tree To Be Removed	[Symbol] / X
Property Line	[Symbol]

Existing Curb Cut Ramp	Symbol
Coping	[Symbol]
Alley Crossing/Driveway	[Symbol]
Edge of Pavement	[Symbol]
Fence	[Symbol]
Cornerstone	[Symbol]
Property Pin	[Symbol]
Utility Pole	[Symbol]
Proposed Sewer	[Symbol]
Manhole	[Symbol]
Basin	[Symbol]
Curb & Gutter	[Symbol]
Asphalt	[Symbol]

Proposed Conc. Sidewalk	Symbol
Brick Sidewalk	[Symbol]
Castings: Water Valve	[Symbol]
Water Meter	[Symbol]
Gas Drip	[Symbol]
Gas Valve	[Symbol]
Telephone Manhole	[Symbol]
Electric Manhole	[Symbol]
Utility Pole	[Symbol]
Proposed Curb Cut Ramp	[Symbol]
Decorative Light	[Symbol]
Conduit	[Symbol]
Conduit (Conc. Encased)	[Symbol]
Retaining Wall	[Symbol]



DEPARTMENT OF PUBLIC WORKS
RICHMOND, VIRGINIA



FOREST HILL AVE. BICYCLE AND PEDESTRIAN SAFETY IMPROVEMENTS
EXISTING TYPICAL SECTIONS

DESIGN BY:	REVIEWED BY:	FIELD NOTES:	SCALE:	DATE:	SHEET:	DRAWING NO.:
DRL		FB-XX, pp XX-XX	HORIZ: N/A VERT: N/A	-/-/-	02A	

FOREST HILL AVE. & 41ST ST.
STA. 10+00 TO STA. 13+25

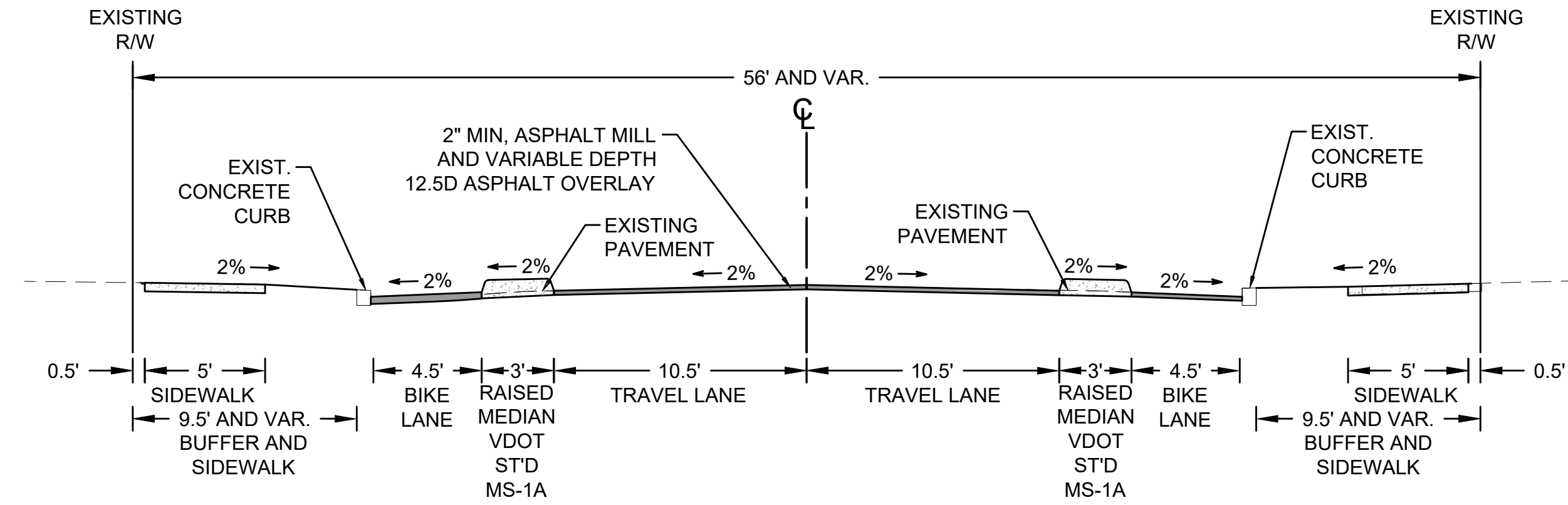

FOREST HILL AVE. & 43RD ST.
STA. 10+00 TO STA. 13+25

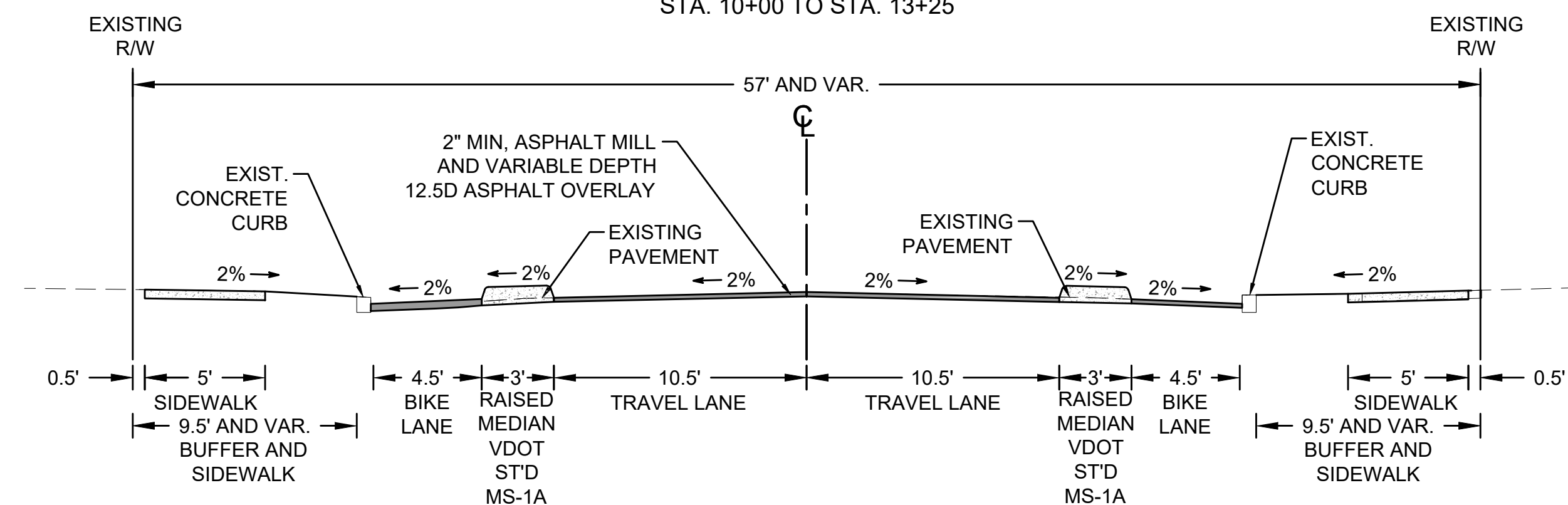

MARCH 2024
60% PRELIMINARY
DESIGN PLANS
NOT FOR CONSTRUCTION

SURVEYED BY:
SUPERVISED BY:
DESIGNED BY:

L:\2024\7064-Richmond_CIP_Or_Cat\028-2024-Forest_Hill_PEP_7857\DWG\Sheet\CD\57064_028-2024-C-02A.dwg | Printed on 3/8/2024 1:01 PM | by Vince Sheehan

NOTES

1. Lot dimensions in parentheses are from deed.
2. Property owners correct as of December, 2018
3. Ordinance Number N/A
4. Adopted N/A
5. Accepted N/A

REFERENCES	REVISIONS

Existing Curb	Symbol
Curb & Gutter	=====
Sidewalk	=====
Basin	=====
Storm Sewer	=====
Sewer Manhole	=====
Sanitary Sewer (sewer)	=====
Sanitary Sewer (raw main)	=====
Gas Line	=====
Electric Line	=====
Telephone/Telegraph	=====
TV Cable	=====
Water Line	=====
Tree / Exist. Tree To Be Removed	⊗ / X
Property Line	=====

Existing Curb Cut Ramp	Symbol
Coping	=====
Alley Crossing/Driveway	=====
Fire Hydrant	=====
Edge of Pavement	=====
Fence	=====
Cornerstone	=====
Gas Line	=====
Electric Line	=====
Utility Pole	=====
Proposed Sewer	=====
Manhole	=====
Basin	=====
Curb & Gutter	=====
Asphalt	=====

Proposed Conc. Sidewalk	Symbol
Brick Sidewalk	=====
Castings: Water Valve	=====
Water Meter	=====
Gas Trip	=====
Gas Valve	=====
Telephone Manhole	=====
Electric Manhole	=====
Proposed Curb Cut Ramp	=====
Decorative Light	=====
Conduit	=====
Conduit (Conc. Encased)	=====
Retaining Wall	=====



DEPARTMENT OF PUBLIC WORKS
RICHMOND, VIRGINIA



FOREST HILL AVE. BICYCLE AND PEDESTRIAN SAFETY IMPROVEMENTS
PROPOSED TYPICAL SECTION

DESIGN BY:	REVIEWED BY:	FIELD NOTES:	SCALE:	DATE:	SHEET:	DRAWING NO.:
DRL		FB-XX, pp XX-XX	HORIZ N/A VERT N/A	-/-/-	02B	

SURVEYED BY:
 SUPERVISED BY:
 DESIGNED BY:

L:\2023\7064-Richmond_CIP_Or-Call\228-208-Forest_Hill_PEP_7857\DWG\Sheet\CD\57064_028-208-C-03x.dwg | Plotted on 3/29/2024 1:03 PM | by Vince Sheehan

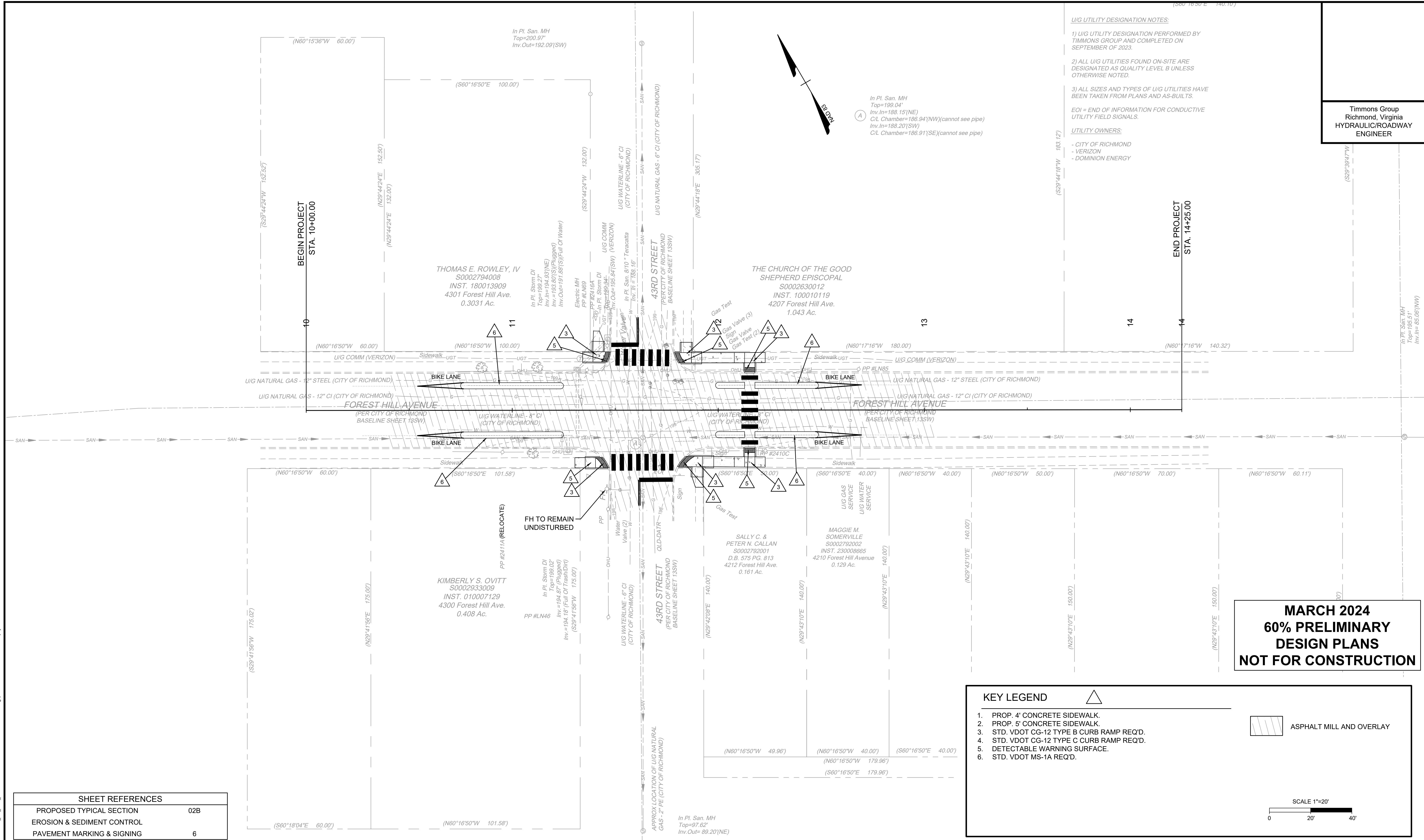

U/G UTILITY DESIGNATION NOTES:

- 1) U/G UTILITY DESIGNATION PERFORMED BY TIMMONS GROUP AND COMPLETED ON SEPTEMBER OF 2023.
- 2) ALL U/G UTILITIES FOUND ON-SITE ARE DESIGNATED AS QUALITY LEVEL B UNLESS OTHERWISE NOTED.
- 3) ALL SIZES AND TYPES OF U/G UTILITIES HAVE BEEN TAKEN FROM PLANS AND AS-BUILTS.

E.O.I. = END OF INFORMATION FOR CONDUCTIVE UTILITY FIELD SIGNALS.

UTILITY OWNERS:

- CITY OF RICHMOND
- VERIZON
- DOMINION ENERGY

Timmons Group
 Richmond, Virginia
 HYDRAULIC/ROADWAY
 ENGINEER

**MARCH 2024
 60% PRELIMINARY
 DESIGN PLANS
 NOT FOR CONSTRUCTION**

KEY LEGEND

1. PROP. 4' CONCRETE SIDEWALK.	
2. PROP. 5' CONCRETE SIDEWALK.	
3. STD. VDOT CG-12 TYPE B CURB RAMP REQ'D.	
4. STD. VDOT CG-12 TYPE C CURB RAMP REQ'D.	
5. DETECTABLE WARNING SURFACE.	
6. STD. VDOT MS-1A REQ'D.	

ASPHALT MILL AND OVERLAY

SCALE 1"=20'

0 20' 40'

SHEET REFERENCES	
PROPOSED TYPICAL SECTION	02B
EROSION & SEDIMENT CONTROL	6
PAVEMENT MARKING & SIGNING	6

NOTES

1. Lot dimensions in parentheses are from deed.
2. Property owners correct as of December, 2018
3. Ordinance Number N/A
4. Adopted N/A
5. Accepted N/A

EXISTING	PROPOSED
Curb & Gutter	Proposed Conc. Sidewalk
Sidewalk	Brick Sidewalk
Basin	Castings: Water Valve
Storm Sewer	Fire Hydrant
Sewer Manhole	Gas Drip
Sanitary Sewer (sewer)	Gas Valve
Sanitary Sewer (raw main)	Telephone Manhole
Gas Line	Electric Manhole
Electric Line	Utility Pole
Telephone/Telegraph	Proposed Curb Cut Ramp
TV Cable	Decorative Light
Water Line	Conduit (Conc. Encased)
Tree / Exist. Tree To Be Removed	Retaining Wall
Property Line	



DESIGN BY: DRL	REVIEWED BY:	FIELD NOTES: FB-XX, PP XX-XX	SCALE: HORIZ N/A, VERT N/A	DATE: -/-/	SHEET: 03	DRAWING NO.:
DRAWN BY: CCC	CHECKED BY: DRL					

SURVEYED BY:
 SUPERVISED BY:
 DESIGNED BY:

L:\2023\7064-Richmond_CIP_On-Call\2023-2024-Forest_Hill_PEP_7857\DWG\Sheet\CD\57064_028-2023-2024-Forest_Hill_PEP.dwg | Plotted on 3/19/2024 1:03 PM by Vince Sheehan

U/G UTILITY DESIGNATION NOTES:

- 1) U/G UTILITY DESIGNATION PERFORMED BY TIMMONS GROUP AND COMPLETED ON SEPTEMBER OF 2023.
- 2) ALL U/G UTILITIES FOUND ON-SITE ARE DESIGNATED AS QUALITY LEVEL B UNLESS OTHERWISE NOTED.
- 3) ALL SIZES AND TYPES OF U/G UTILITIES HAVE BEEN TAKEN FROM PLANS AND AS-BUILTS.

EOI = END OF INFORMATION FOR CONDUCTIVE UTILITY FIELD SIGNALS.

UTILITY OWNERS:

- CITY OF RICHMOND
- VERIZON
- DOMINION ENERGY

Timmons Group
 Richmond, Virginia
 HYDRAULIC/ROADWAY
 ENGINEER

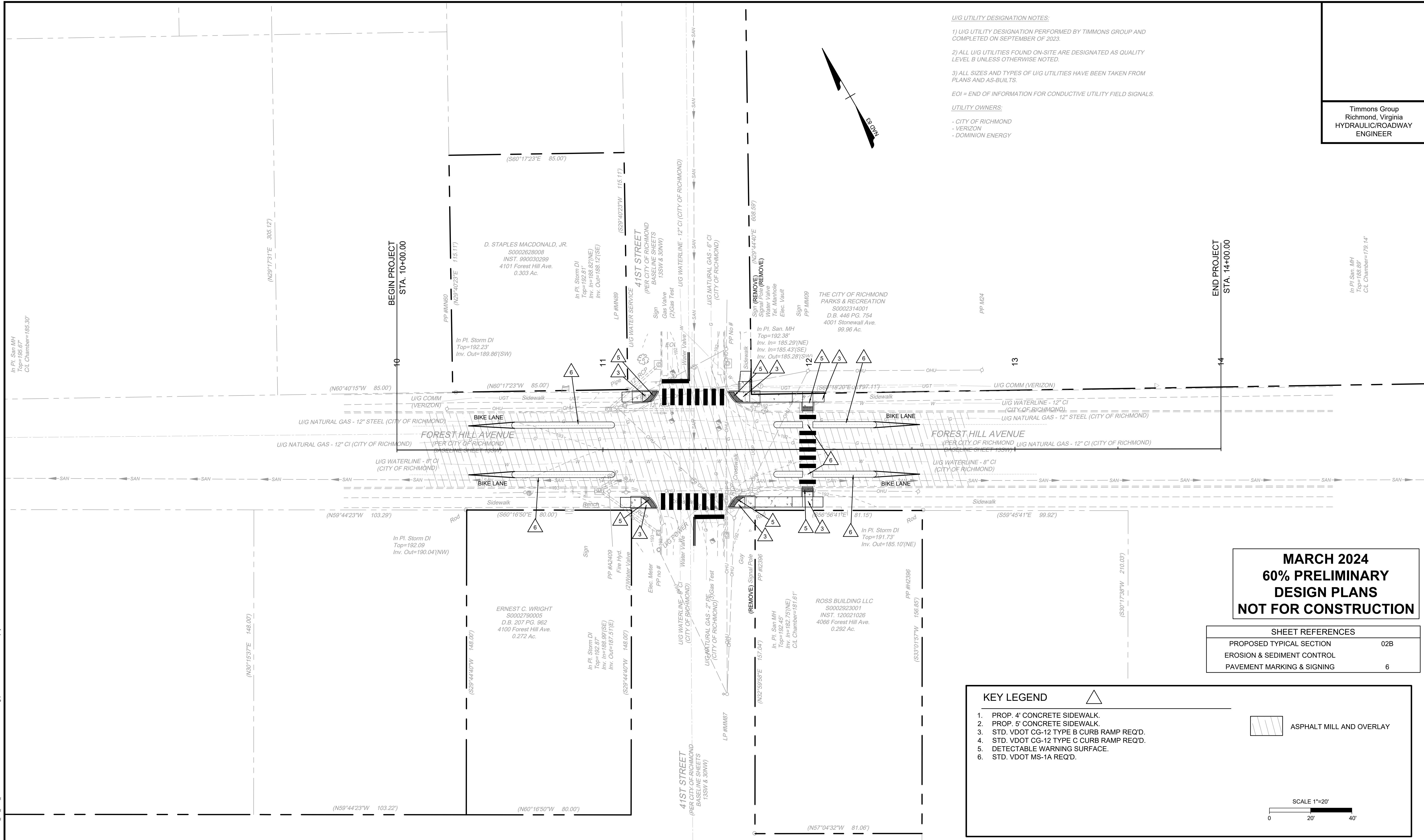

MARCH 2024
60% PRELIMINARY
DESIGN PLANS
NOT FOR CONSTRUCTION

SHEET REFERENCES	
PROPOSED TYPICAL SECTION	02B
EROSION & SEDIMENT CONTROL	
PAVEMENT MARKING & SIGNING	6

KEY LEGEND

1. PROP. 4' CONCRETE SIDEWALK.	
2. PROP. 5' CONCRETE SIDEWALK.	
3. STD. VDOT CG-12 TYPE B CURB RAMP REQ'D.	
4. STD. VDOT CG-12 TYPE C CURB RAMP REQ'D.	
5. DETECTABLE WARNING SURFACE.	
6. STD. VDOT MS-1A REQ'D.	

ASPHALT MILL AND OVERLAY

SCALE 1"=20'

NOTES

1. Lot dimensions in parentheses are from deed.
2. Property owners correct as of December, 2018
3. Ordinance Number N/A
4. Adopted N/A
5. Accepted N/A

EXISTING	PROPOSED
<ul style="list-style-type: none"> Curb & Gutter Sidewalk Basin Storm Sewer Sewer Manhole Sanitary Sewer (sewer) Sanitary Sewer (raw main) Gas Line Electric Line Telephone/Telegraph TV Cable Water Line Tree / Exist. Tree To Be Removed Property Line 	<ul style="list-style-type: none"> Proposed Conc. Sidewalk Proposed Brick Sidewalk Castings: Water Valve Fire Hydrant Gas Trip Gas Valve Telephone Manhole Electric Manhole Utility Pole Proposed Curb Cut Ramp Decorative Light Conduit (Conc. Encased) Retaining Wall



FOREST HILL AVE. BICYCLE AND PEDESTRIAN SAFETY IMPROVEMENTS
41ST ST. PLAN SHEET

DESIGN BY: DRL	REVIEWED BY:	FIELD NOTES: FB-XX, pp XX-XX	SCALE: HORIZ N/A, VERT N/A	DATE: -/-/-	SHEET: 04	DRAWING NO.:
----------------	--------------	------------------------------	----------------------------	-------------	-----------	--------------

RECTANGULAR RAPID FLASHING BEACON DETAIL

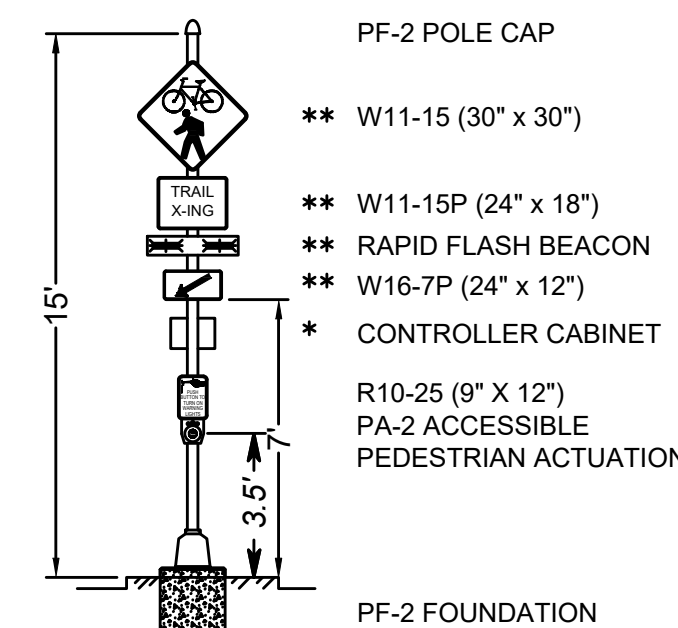

- * CONTROLLER CABINET LOCATED ON POLE A ONLY
- ** ONE SIDE PER DIRECTION INSTALLED BACK TO BACK

- APS ACTUATION NOTES:**
1. APS ACTUATION SHALL BE EQUIPPED WITH A LOCATOR TONE.
 2. VIBROTACTILE INDICATIONS OR PERCUSSIVE TONES SHALL NOT BE USED.
 3. WHEN APS BUTTON IS PRESSED AND WARNING LIGHTS ARE ACTIVATED, PUSH BUTTON SHALL ANNOUNCE THE FOLLOWING SPEECH MESSAGE TWICE: "YELLOW LIGHTS ARE FLASHING".

PROPOSED SIGNS

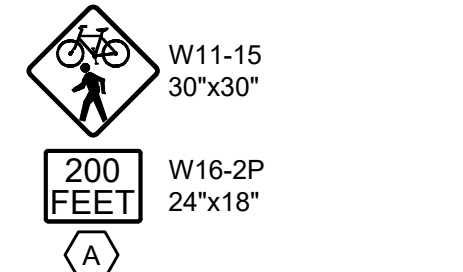

SIGNAL POLE & CONTROLLER LEGEND

(ALL DIMENSIONS ARE TO FLANGE PLATE)

- (A) PEDESTAL POLE (PF-2), 15' RRFB CONTROLLER CABINET ON POLE. INSTALL SIGNS AND PA-2 ACTUATION PER RRFB DETAIL.
- (B) PEDESTAL POLE (PF-2), 15' INSTALL SIGNS AND PA-2 ACTUATION PER RRFB DETAIL.
- (C) SE-5 ELECTRIC SERVICE POLE. METER BASE SHALL BE INSTALLED AS A BOTTOM FEED PER THE 2016 ROAD AND BRIDGE STANDARDS. ELECTRICAL SERVICE WORK PAD REQUIRED.

CABLE AND CONDUIT LEGEND

- (A) 1-2" CONDUIT
 - 1 - 14/3C
 - 1 - 14/2C(S)(PB)
 - 1 - EGC
 - (B) 1-2" BORED CONDUIT
 - 1 - 14/3C
 - 1 - 14/2C(S)(PB)
 - 1 - EGC
 - (C) 1-2" CONDUIT
 - 1 - 8/3C (POWER)
 - 1 - EGC
 - (D) 1-3" CONDUIT DOMINION POWER FEED
- (S) DENOTES "SHIELDED CABLE"
 (PB) DENOTES "PUSH BUTTON"
 EGC DENOTES "EQUIPMENT GROUNDING CONDUCTOR"

- U/G UTILITY DESIGNATION NOTES:**
- 1) U/G UTILITY DESIGNATION PERFORMED BY TIMMONS GROUP AND COMPLETED ON SEPTEMBER OF 2023.
 - 2) ALL U/G UTILITIES FOUND ON-SITE ARE DESIGNATED AS QUALITY LEVEL B UNLESS OTHERWISE NOTED.
 - 3) ALL SIZES AND TYPES OF U/G UTILITIES HAVE BEEN TAKEN FROM PLANS AND AS-BUILTS.
- EOL = END OF INFORMATION FOR CONDUCTIVE UTILITY FIELD SIGNALS.
- UTILITY OWNERS:**
- CITY OF RICHMOND
 - VERIZON
 - DOMINION ENERGY

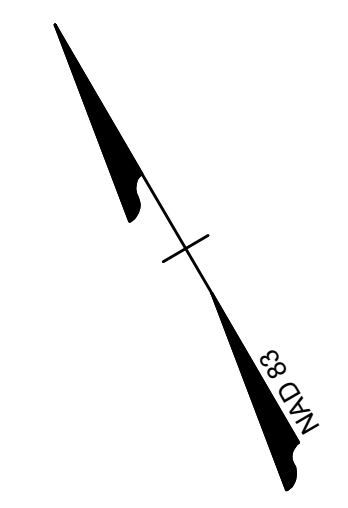

Timmons Group
 Richmond, Virginia
 HYDRAULIC/ROADWAY
 ENGINEER

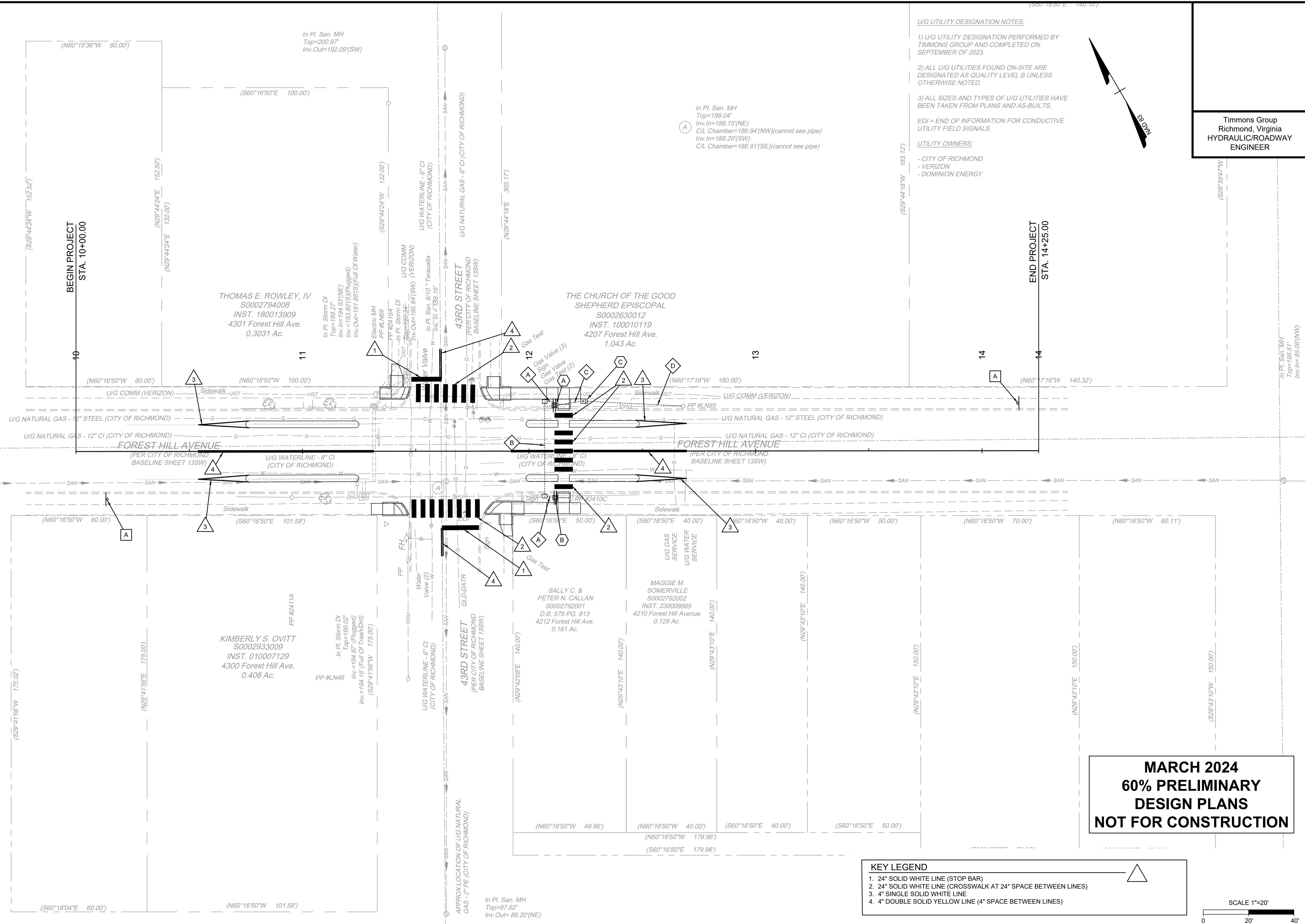

**MARCH 2024
 60% PRELIMINARY
 DESIGN PLANS
 NOT FOR CONSTRUCTION**

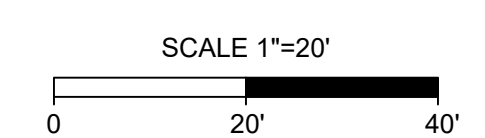
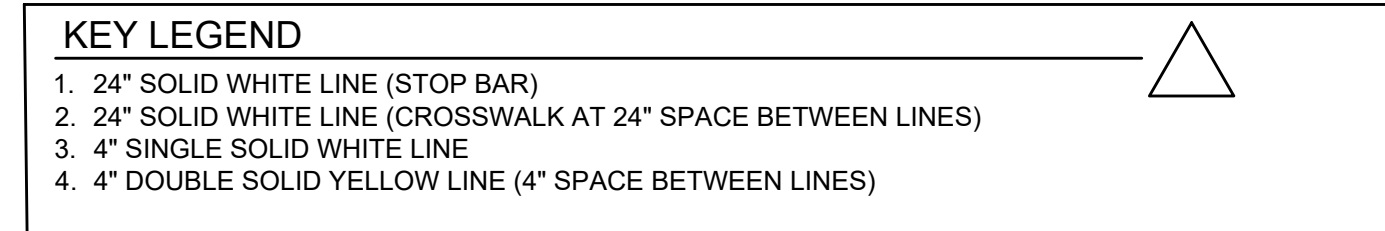

SURVEYED BY: ...
 SUPERVISED BY: ...
 DESIGNED BY: ...
 L:\2023\7064-Richmond_CIP_On-Call\2023-2024-Forest_Hill_PEP_7857\DWG\Sheet\CD\57084_028-2023-06-06.dwg | Plotted on 3/19/2024 1:04 PM by Vince Sheehan

NOTES

1. Lot dimensions in parentheses are from deed.
2. Property owners correct as of December, 2018
3. Ordinance Number N/A
4. Adopted N/A
5. Accepted N/A

EXISTING	PROPOSED
Curb & Gutter	Proposed Conc. Sidewalk
Sidewalk	Brick Sidewalk
Basin	Castings: Water Valve
Storm Sewer	Water Meter
Sewer Manhole	Gas Drop
Sanitary Sewer (sewer)	Gas Valve
Sanitary Sewer (raw main)	Telephone Manhole
Gas Line	Electric Manhole
Electric Line	Utility Pole
Telephone/Telegraph	Proposed Curb Cut Ramp
TV Cable	Decorative Light
Water Line	Conduit (Conc. Encased)
Tree / Exist. Tree To Be Removed	Retaining Wall
Property Line	



**FOREST HILL AVE. BICYCLE AND PEDESTRIAN SAFETY IMPROVEMENTS
 43RD ST. PAVEMENT MARKING & SIGNING SHEET**

DESIGN BY: DRL	REVIEWED BY:	FIELD NOTES: FB-XX, PP XX-XX	SCALE: HORIZ: N/A, VERT: N/A	DATE: -/-/-	SHEET: 05	DRAWING NO.:
DRAWN BY: CCC	CHECKED BY: DRL					

U/G UTILITY DESIGNATION NOTES:

- 1) U/G UTILITY DESIGNATION PERFORMED BY TIMMONS GROUP AND COMPLETED ON SEPTEMBER OF 2023.
- 2) ALL U/G UTILITIES FOUND ON-SITE ARE DESIGNATED AS QUALITY LEVEL B UNLESS OTHERWISE NOTED.
- 3) ALL SIZES AND TYPES OF U/G UTILITIES HAVE BEEN TAKEN FROM PLANS AND AS-BUILTS.

EOI = END OF INFORMATION FOR CONDUCTIVE UTILITY FIELD SIGNALS.

UTILITY OWNERS:

- CITY OF RICHMOND
- VERIZON
- DOMINION ENERGY

Timmons Group
Richmond, Virginia
HYDRAULIC/ROADWAY
ENGINEER

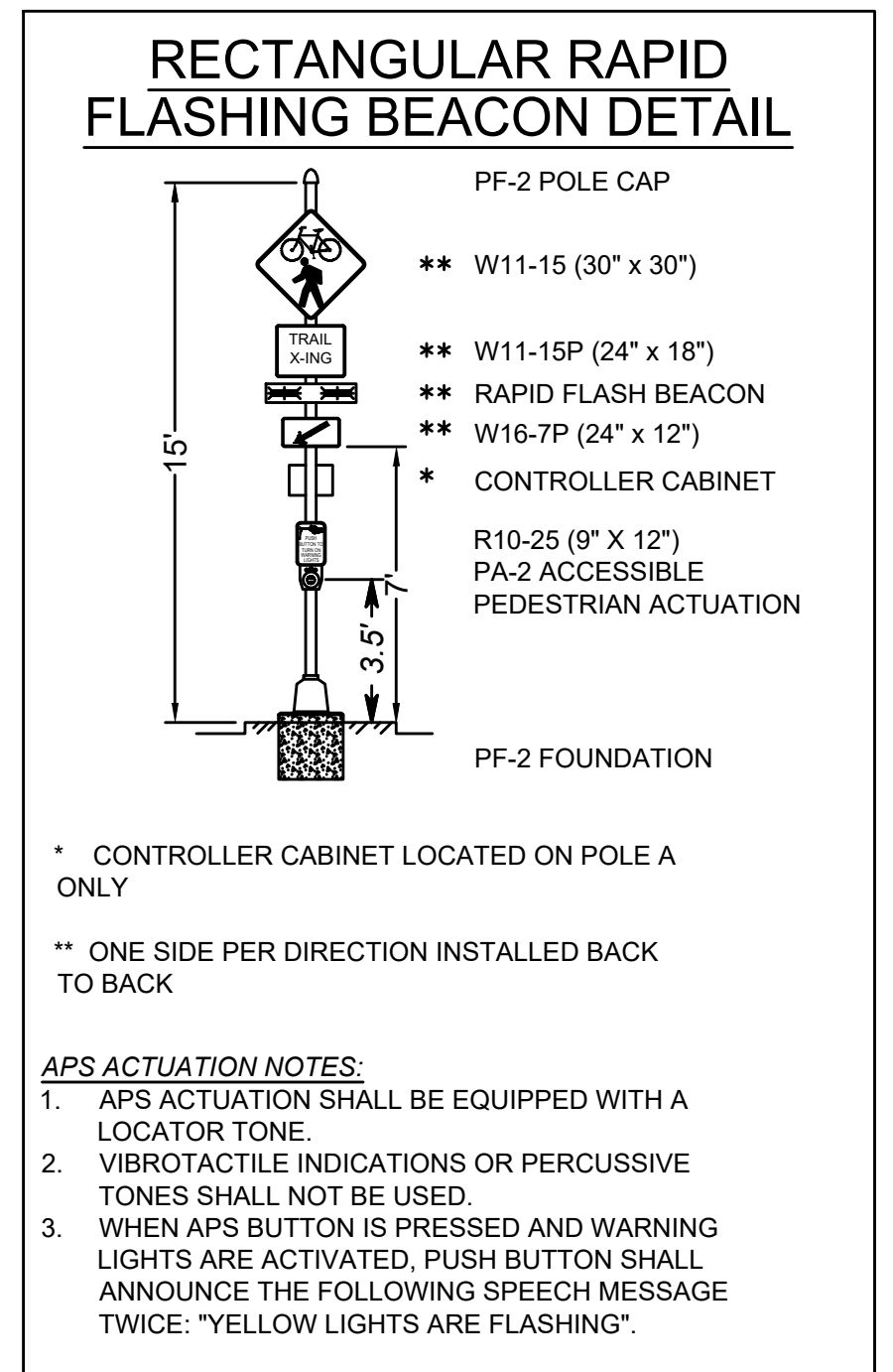

In Pl. San MH
Top=156.67'
C/L Chamber=155.30'

In Pl. San MH
Top=168.89'
C/L Chamber=179.14'

SIGNAL POLE & CONTROLLER LEGEND
(ALL DIMENSIONS ARE TO FLANGE PLATE)

- A** PEDESTAL POLE (PF-2), 15' RFRB CONTROLLER CABINET ON POLE. INSTALL SIGNS AND PA-2 ACTUATION PER RFRB DETAIL.
- B** PEDESTAL POLE (PF-2), 15'. INSTALL SIGNS AND PA-2 ACTUATION PER RFRB DETAIL.
- C** SE-5 ELECTRIC SERVICE POLE. METER BASE SHALL BE INSTALLED AS A BOTTOM FEED PER THE 2016 ROAD AND BRIDGE STANDARDS. ELECTRICAL SERVICE WORK PAD REQUIRED.

CABLE AND CONDUIT LEGEND

- A** 1-2" CONDUIT
 - 1- 14/3C
 - 1- 14/2C(S)(PB)
 - 1- EGC
- B** 1-2" BORED CONDUIT
 - 1- 14/3C
 - 1- 14/2C(S)(PB)
 - 1- EGC
- C** 1-2" CONDUIT
 - 1- 8/3C (POWER)
 - 1- EGC
- D** 1-3" CONDUIT
 - DOMINION POWER FEED

(S) DENOTES "SHIELDED CABLE"
(PB) DENOTES "PUSH BUTTON"
EGC DENOTES "EQUIPMENT GROUNDING CONDUCTOR"

NOTES

1. Lot dimensions in parentheses are from deed.
2. Property owners correct as of December, 2018
3. Ordinance Number N/A
4. Adopted N/A
5. Accepted N/A

REFERENCES	REVISIONS

Existing	Proposed
Curb & Gutter	Proposed Conc. Sidewalk
Sidewalk	Proposed Brick Sidewalk
Basin	Castings: Water Valve
Storm Sewer	• Fire Hydrant
Sewer Manhole	• Gas Drip
Sanitary Sewer (sewer)	• Gas Valve
Sanitary Sewer (raw main)	• Telephone Manhole
Gas Line	• Electric Manhole
Electric Line	• Utility Pole
Telephone/Telegraph	Proposed Curb Cut Ramp
TV Cable	• Decorative Light
Water Line	• Conduit (Conc. Encased)
Tree / Exist. Tree To Be Removed	• Retaining Wall
Property Line	



TIMMONS GROUP
ENGINEERING | DESIGN | TECHNOLOGY

**FOREST HILL AVE. BICYCLE AND PEDESTRIAN SAFETY IMPROVEMENTS
41ST ST. PAVEMENT MARKING & SIGNING SHEET**

DESIGN BY: DRL	REVIEWED BY:	FIELD NOTES: FB-XX, PP XX-XX	SCALE: HORIZ N/A, VERT. N/A	DATE: -/-/-	SHEET: 06	DRAWING NO.:
DRAWN BY: CCC						
CHECKED BY: DRL						

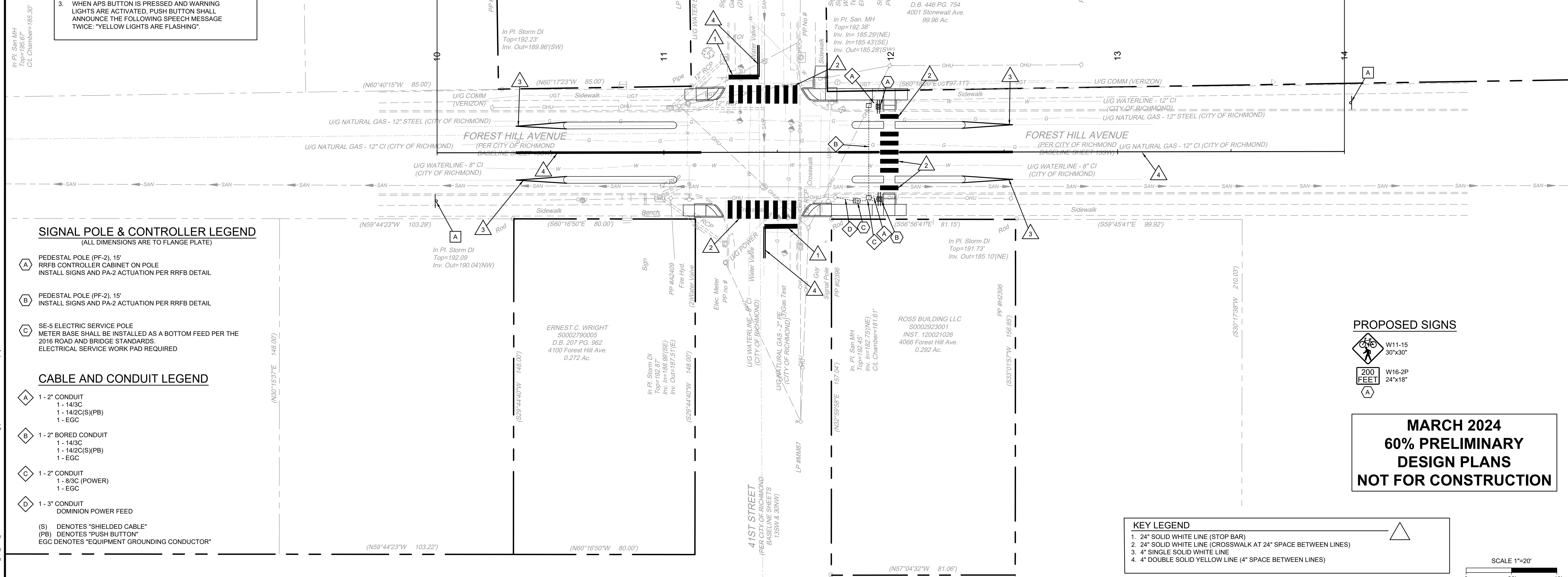

PROPOSED SIGNS

- W11-15 (30" x 30")
- W16-2P (24" x 18")

**MARCH 2024
60% PRELIMINARY
DESIGN PLANS
NOT FOR CONSTRUCTION**

KEY LEGEND

1. 24" SOLID WHITE LINE (STOP BAR)
2. 24" SOLID WHITE LINE (CROSSWALK AT 24" SPACE BETWEEN LINES)
3. 4" SINGLE SOLID WHITE LINE
4. 4" DOUBLE SOLID YELLOW LINE (4" SPACE BETWEEN LINES)

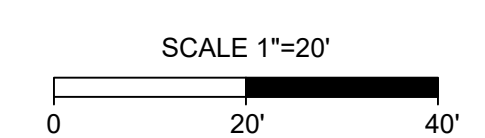

L:\2023\7064-Richmond_CIP_On-Call\2023-2024-Forest_Hill_PEP_7857\DWG\Sheet\CD\57064_028-2023-2024-Forest_Hill_PEP.dwg | Plotted on 3/19/2024 1:04 PM by Vince Sheehan

Timmons Group
Richmond, Virginia
HYDRAULIC/ROADWAY
ENGINEER

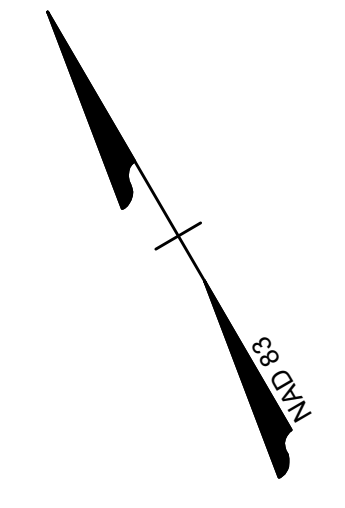

THOMAS E. ROWLEY, IV
S0002794008
INST. 180013909
4301 Forest Hill Ave.
0.3031 Ac.

In Pl. Storm DI
Top=199.27'
Inv.=194.93'(NE)
Inv.=193.80'(S)(Plugged)
Inv. Out=191.88'(S)(Full Of Wa

THE CHURCH OF THE GOOD
SHEPHERD EPISCOPAL
S0002630012
INST. 100010119
4207 Forest Hill Ave.
1.043 Ac.

In Pl. Storm DI
Top=199.34'
Inv. Out=195.84'(SW)

43RD STREET
(PER CITY OF RICHMOND
BASELINE SHEET 13SW)

43RD STREET
(PER CITY OF RICHMOND
BASELINE SHEET 13SW)

(N60°16'50"W 100.00')

(N60°17'16"W 180.00')

BEGIN PROJECT
STA. 10+00.00

Load Garbage Truck
NCHRP REPORT 659 2010 (US)

Rear-Load Garbage Truck
NCHRP REPORT 659 2010 (US)

FOREST HILL AVENUE
(PER CITY OF RICHMOND
BASELINE SHEET 13SW)

FOREST HILL AVENUE
(PER CITY OF RICHMOND
BASELINE SHEET 13SW)

(N29°41'56"E 175.00')

(S60°16'50"E 101.58')

(S60°16'50"E 50.00')

(S60°16'50"E 40.00')

(N60°16'50"W 40.00')

(N60°16'50"W 40.00')

KIMBERLY S. OVITT
S0002933009
INST. 010007129
4300 Forest Hill Ave.
0.408 Ac.

In Pl. Storm DI
Top=199.02'
Inv.=194.87' (Plugged)
Inv.=194.18' (Full Of Trash/Dirt)
(S29°41'56"W 175.00')

SALLY C. &
PETER N. CALLAN
S0002792001
D.B. 575 PG. 813
4212 Forest Hill Ave.
0.161 Ac.

MAGGIE M.
SOMERVILLE
S0002792002
INST. 230008665
4210 Forest Hill Avenue
0.129 Ac.

**MARCH 2024
60% PRELIMINARY
DESIGN PLANS
NOT FOR CONSTRUCTION**

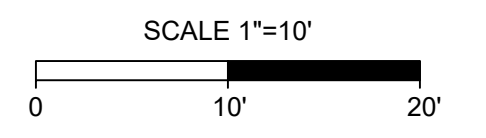

NOTES
1. Lot dimensions in parentheses are from deed.
2. Property owners correct as of December, 2018.
3. Ordinance Number N/A
4. Adopted N/A
5. Accepted N/A

Existing	Proposed
Curb & Gutter	Proposed Conc. Sidewalk
Sidewalk	Proposed Brick Sidewalk
Basin	Castings: Water Valve
Storm Sewer	Water Meter
Sewer Manhole	Gas Drop
Sanitary Sewer (sewer)	Gas Valve
Sanitary Sewer (raw main)	Telephone Manhole
Gas Line	Electric Manhole
Electric Line	Utility Pole
Telephone/Telegraph	Proposed Curb Cut Ramp
TV Cable	Decorative Light
Water Line	Conduit (Conc. Encased)
Tree / Exist. Tree To Be Removed	Retaining Wall
Property Line	



DESIGN BY: DRL	REVIEWED BY:	FIELD NOTES: FB-XX, pp XX-XX	SCALE: HORIZ N/A, VERT N/A	DATE: -/-/	SHEET: 09	DRAWING NO.:
----------------	--------------	------------------------------	----------------------------	------------	-----------	--------------

L:\2023\7064-Richmond_CIP_On-Call\2023-2024\Forest_Hill_FEP_7857\DWG\Sheet\Exhibit\7064_028-2023C-VHCL.dwg | Printed on 3/8/2024 1:05 PM by Vince Sheehan

SURVEYED BY: ...
SUPERVISED BY: ...
DESIGNED BY: ...

Timmons Group
Richmond, Virginia
HYDRAULIC/ROADWAY
ENGINEER

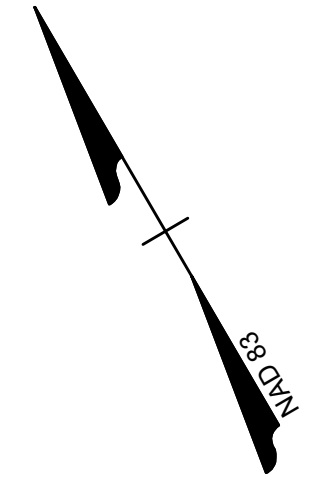

D. STAPLES MACDONALD, JR.
S0002628008
INST. 990030299
4101 Forest Hill Ave.
0.303 Ac.

THE CITY OF RICHMOND
PARKS & RECREATION
S0002314001
D.B. 446 PG. 754
4001 Stonewall Ave.
99.96 Ac.

ERNEST C. WRIGHT
S0002790005
D.B. 207 PG. 962
4100 Forest Hill Ave.
0.272 Ac.

ROSS BUILDING LLC
S0002923001
INST. 120021026
4066 Forest Hill Ave.
0.292 Ac.

MARCH 2024
60% PRELIMINARY
DESIGN PLANS
NOT FOR CONSTRUCTION

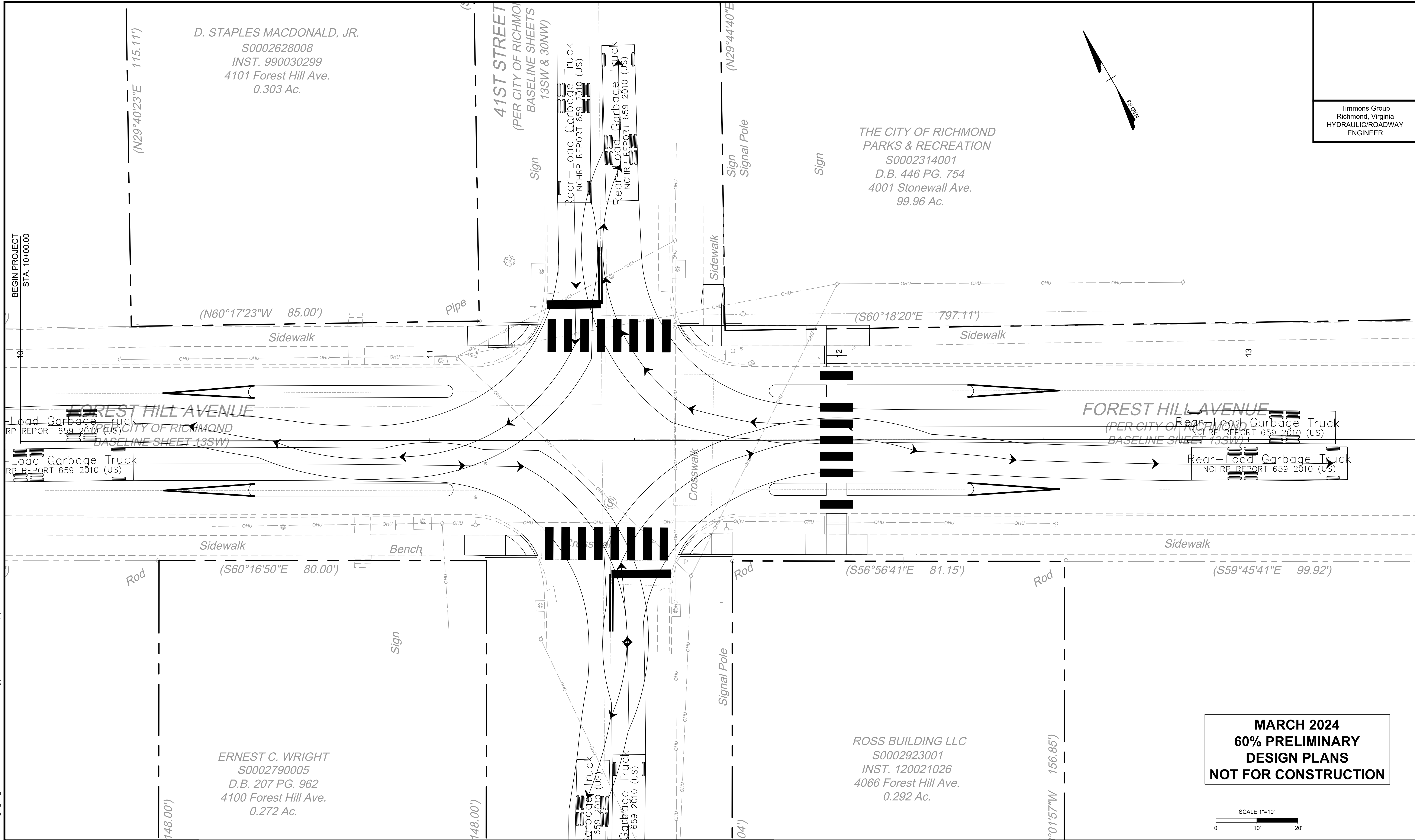
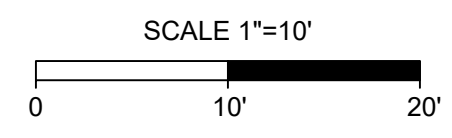

SURVEYED BY: ...
 SUPERVISED BY: ...
 DESIGNED BY: ...
 L:\2023\76764-Richmond_CIP_04-Cali\2023-Sheet\Richmond_Hill_FEP_767\DWG\Sheet\Richmond_Hill_FEP_767.dwg | Printed on 3/8/2024 1:05 PM | by Vince Sheehan

NOTES

1. Lot dimensions in parentheses are from deed.
2. Property owners correct as of December, 2018
3. Ordinance Number *N/A*
4. Adopted *N/A*
5. Accepted *N/A*

REFERENCES	REVISIONS

LEGEND

Existing Curb	Proposed Conc. Sidewalk
• Curb & Gutter	• Brick Sidewalk
• Sidewalk	• Castings: Water Valve
• Basin	• Water Meter
• Storm Sewer	• Gas Drip
• Sewer Manhole	• Gas Valve
• Sanitary Sewer (sewer)	• Telephone Manhole
• Sanitary Sewer (raw main)	• Electric Manhole
• Gas Line	• Electric Manhole
• Electric Line	• Utility Pole
• Telephone/Telegraph	• Proposed Curb Cut Ramp
• TV Cable	• Decorative Light
• Water Line	• Conduit (Conc. Encased)
• Tree / Exist. Tree To Be Removed	• Retaining Wall
• Property Line	



FOREST HILL AVE. BICYCLE AND PEDESTRIAN SAFETY IMPROVEMENTS
TURNING MOVEMENT 43RD ST.

DESIGN BY:	REVIEWED BY:	FIELD NOTES:	SCALE:	DATE:	SHEET:	DRAWING NO.:
DRL		FB-XX, PP XX-XX	HORIZ: N/A VERT: N/A	-/-/-	10	