



Department of Public Utilities

Chimborazo Drop Shaft and Sanitary Sewer Replacement Phase I

Mayor Levar M. Stoney

Project Information

The Chimborazo Drop Shaft and Sanitary Sewer Rehabilitation Phase I project includes the replacement of the portion of sewer that runs from the top of Chimborazo Hill to the bottom of the hillside in the abandoned railroad bed. This project is a permanent replacement for the emergency repaired portion of the brick step sewer that was damaged during the 2004 slope failure caused by Tropical Storm Gaston and has been designed in such a way to avoid potentially unstable soils. The slope between E. Grace Street and the abandoned railroad bed has failed multiple times since the construction of the rail spur. Most recently, the slope failed during the heavy rainfall event of Tropical Storm Gaston in 2004 and again in 2017. As a result of that storm, much of the hill surrounding Chimborazo Park in the Church Hill area became unstable. The large amount of precipitation received during the storm increased the hydrostatic ground water pressure which eventually triggered slope failure. Emergency sewer repair work was done in 2005 and again in 2017 as temporary solutions to put the Chimborazo interceptor sewer back in service after the collapse and damage caused by the storms.

Project Status

The sanitary sewer is in service, marking substantial project completion. Remaining work includes backfilling the trench along E. Grace Street and surface restoration. The project is progressing to be completed ahead of schedule with estimated completion by April 2024.

Current Work

By-pass pumping and system testing have been completed. Activity continues in the intersection of 32nd and E. Grace Streets as crews excavate and tie the existing stormwater infrastructure to the new system. This will include heavy equipment operation and increased truck traffic to remove spoils and bring in backfill for the trenches. The City's contractor, Southwood, has almost finished backfilling at the top of the hill and will start the lateral/storm drain work. Remaining tasks include site restoration, curb and gutter, sidewalks and paving. We thank you for continued patience.

REMINDER: Please keep dogs/pets on their leashes while outside of the fenced in dog park area. It is dangerous for them and for construction workers in the lower hillside construction zone.

Chimborazo Drop Shaft and Sanitary Sewer Replacement Project Phase 1

Project Site

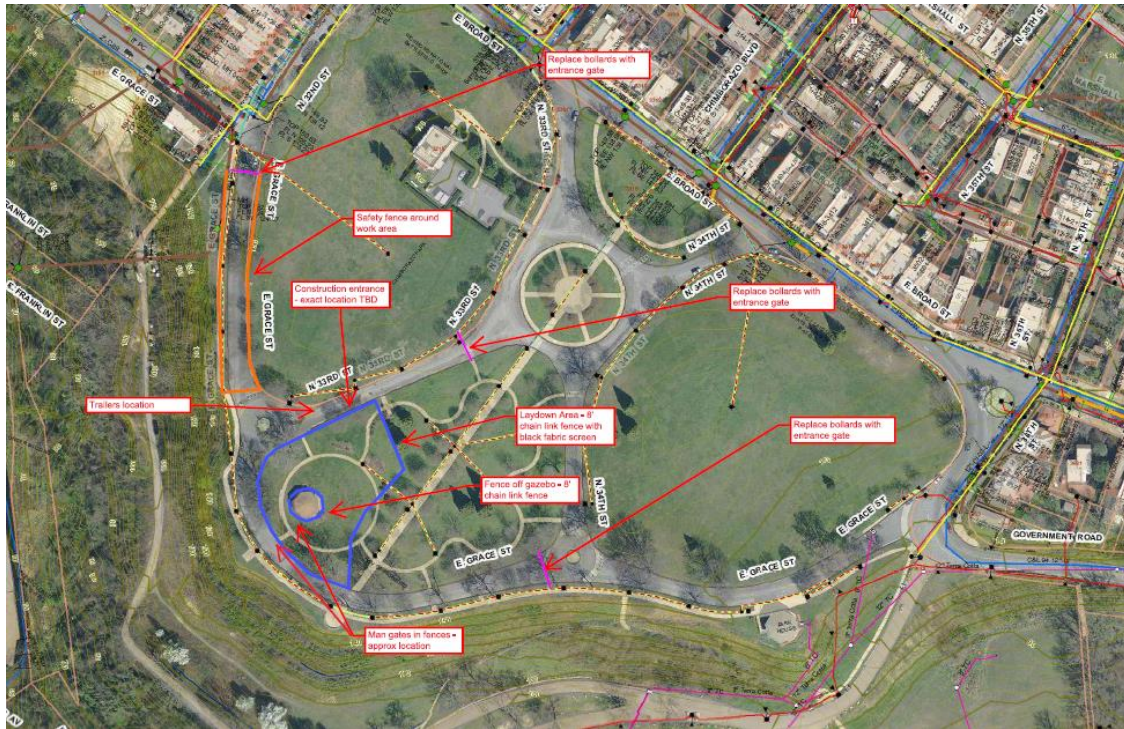

Frequently Asked Questions

What are the project details?

This project consists of constructing a new 10-foot internal diameter inlet chamber manhole and a new 18-foot internal diameter drop shaft chamber located at the top of the existing slope in E. Grace Street. The depths of the inlet chamber and drop shaft chamber wall will be approximately 35 and 100 feet, respectively, below ground surface. The drop shaft chamber will contain a fabricated siphon drop unit to accommodate the long drop. The line out of the drop shaft under the hill will be bored as opposed to open cut to ensure it is below the soils that may be prone to slides in extreme weather. The line along E. Grace St. will also be bored. Open cuts will be done at the bottom of the hill and in the vicinity of E. Grace and N. 32nd Streets. The existing 42", 48", and 60" sewers that this line is replacing will be abandoned in place with flowable fill.

How will this project affect my sewer service, and how will I be notified?

Our goal is to minimize the impact on residents. If there are any impacts, we will notify residents via door hanger notices.

How long will the project take?

Work is scheduled to be completed by July 2024.

Chimborazo Drop Shaft and Sanitary Sewer Replacement Project Phase 1

Will sidewalks be impacted?

The sidewalk on E. Grace Street next to the Chimborazo Hospital will be closed for the duration of the project. In most cases, other sidewalks will remain open for pedestrian traffic. If sidewalks or crosswalks need to be closed for public safety, pedestrians will be rerouted to safer pathways of travel.

How will traffic be affected?

The temporary traffic control plans will allow construction to proceed safely while attempting to minimize impacts to the public. When possible, vehicles will be rerouted past any closed travel lanes but some road closures with detours may occur to maintain a safe pedestrian and vehicular travel environment. Road closures will be posted on the Department of Public Utilities' (DPU) street closing twitter feed (@DPUStreetNews). Every effort will be made to allow access to residences and businesses when it's feasible and safe.

How will parking be impacted?

Parking will be limited for the safety of citizens as well as construction personnel. Any areas of No Parking will be posted at least 48-hours in advance of the work being performed. Please observe and follow directions of "Closed Lanes" and "No Parking" signs around the work zone areas.

What will other impacts be?

There may be some noise as construction vehicles enter and exit the work zone. There will also be some noise and minor vibrations during sheeting and shoring installation to access replacement of deep sewer mains.

Site Restoration Plan

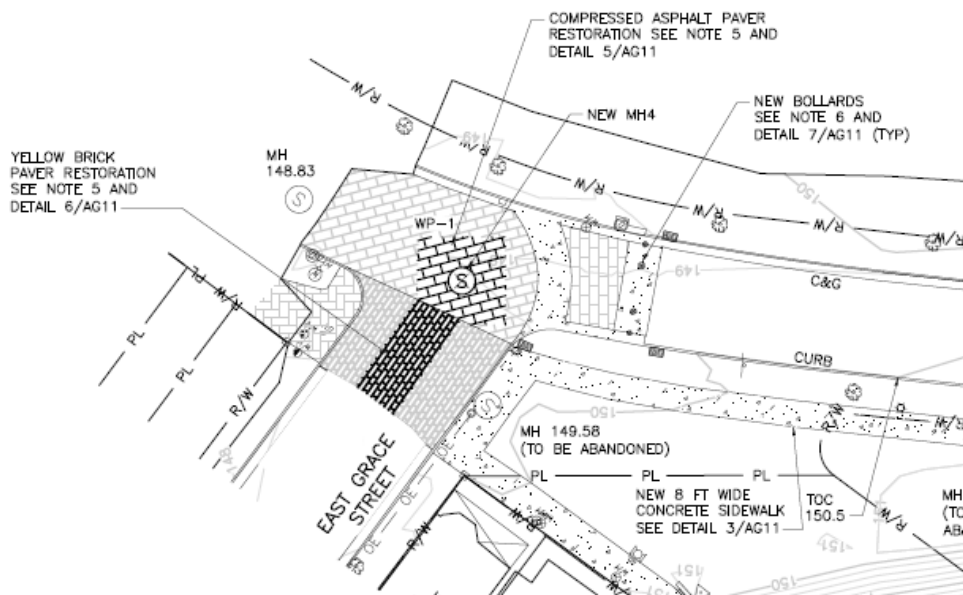

If you have questions or comments about this project, please contact:

Kurt Weishaar, PE

Arcadis Senior Resident Engineer

(804) 646-1400

kurt.weishaar@arcadis.com

Quinton Nottingham

DPU Capital Projects Manager

Department of Public Utilities

(804) 646-5365

Quinton.Nottingham@RVA.gov

Media Contact:

Rhonda Johnson

DPU Public Information Manager

(804) 646-5463

Rhonda.Johnson@RVA.gov